



LEGEND

— EXISTING PROPERTY BOUNDARY

▬ LAND TO BE DESIGNATED FOR ROAD



NOTE
 ALL INFORMATION SHOWN IS SUBJECT TO FINAL DESIGN AND THE DETAILS MAY CHANGE. AREAS AND MEASUREMENTS ARE SUBJECT TO SURVEY.

NOT FOR CONSTRUCTION

REV	DESCRIPTION	DRN	CHK	APP	DATE
D	PROPERTY 221 REMOVED & DESIGNATION AMENDED	MH	JP	JP	10.22
C	ADDITIONAL PARCELS ADDED & OWNER DETAILS UPDATED	MH	JP	JP	21.09.22
B	ISSUED FOR RMA CONSENT	SS	JP	JP	19.08.22
A	ISSUED FOR CONSENT - DRAFT	SS	PP	JP	20.04.22

STATUS	DATE	BY
SURVEYED	-	-
DESIGNED	-	-
DRAWN	21.02.22	Steve Sutton
CAD REVIEW	19.04.22	Steve Sutton
DESIGN CHECK	19.04.22	Jamie Povall
DESIGN REVIEW	19.04.22	Phil Peet
APPROVED	10.10.22	Jamie Povall

Client:



WAKA KOTAHI
 OTAKI TO NORTH OF LEVIN PROJECT

LAND REQUIREMENT PLAN
 SHEET 1

Status Stamp: **FOR CONSENT**

Date Stamp: **10.10.22**

Scale: 1 : 4000 (A3)

Drawing No.: **310203848-01-001-G0200**

Rev: **D**

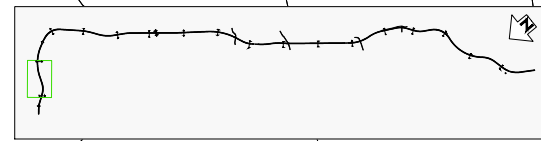

LEGEND	
	EXISTING PROPERTY BOUNDARY
	LAND TO BE DESIGNATED FOR ROAD



NOTE
 ALL INFORMATION SHOWN IS SUBJECT TO FINAL DESIGN AND THE DETAILS MAY CHANGE. AREAS AND MEASUREMENTS ARE SUBJECT TO SURVEY.

NOT FOR CONSTRUCTION

REV	DESCRIPTION	DRN	CHK	APP	DATE
D	PROPERTY 221 REMOVED & DESIGNATION AMENDED	MH	JP	JP	10.10.22
C	ADDITIONAL PARCELS ADDED & OWNER DETAILS UPDATED	MH	JP	JP	21.09.22
B	ISSUED FOR RMA CONSENT	SS	JP	JP	19.08.22
A	ISSUED FOR CONSENT - DRAFT	SS	PP	JP	20.04.22

SURVEYED		
DESIGNED	-	-
DRAWN	Steve Sutton	21.02.22
CAD REVIEW	Steve Sutton	19.04.22
DESIGN CHECK	Jamie Povall	19.04.22
DESIGN REVIEW	Phil Peet	19.04.22
APPROVED	Jamie Povall	10.10.22
PROF REGISTRATION:		



Client:
WAKA KOTAHI
 OTAKI TO NORTH OF LEVIN PROJECT
 LAND REQUIREMENT PLAN
 SHEET 2

Status Stamp	FOR CONSENT
Date Stamp	10.10.22
Scale	1 : 4000 (A3)
Drawing No.	310203848-01-001-G0201
Rev.	D

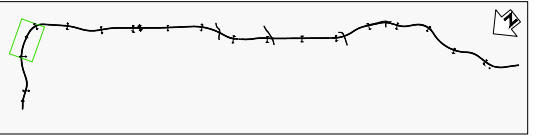

LEGEND

	EXISTING PROPERTY BOUNDARY
	LAND TO BE DESIGNATED FOR ROAD

NOTE
 ALL INFORMATION SHOWN IS SUBJECT TO FINAL DESIGN AND THE DETAILS MAY CHANGE. AREAS AND MEASUREMENTS ARE SUBJECT TO SURVEY.

NOT FOR CONSTRUCTION

REV	DESCRIPTION	DRN	CHK	APP	DATE
D	PROPERTY 221 REMOVED & DESIGNATION AMENDED	MH	JP	JP	10.22
C	ADDITIONAL PARCELS ADDED & OWNER DETAILS UPDATED	MH	JP	JP	21.09.22
B	ISSUED FOR RMA CONSENT	SS	JP	JP	19.08.22
A	ISSUED FOR CONSENT - DRAFT	SS	PP	JP	20.04.22

STATUS	NAME	DATE
SURVEYED	-	-
DESIGNED	-	-
DRAWN	Steve Sutton	21.02.22
CAD REVIEW	Steve Sutton	19.04.22
DESIGN CHECK	Jamie Povall	19.04.22
DESIGN REVIEW	Phil Peet	19.04.22
APPROVED	Jamie Povall	10.10.22



Client: WAKA KOTAHI
 OTAKI TO NORTH OF LEVIN PROJECT
 LAND REQUIREMENT PLAN
 SHEET 3

Status Stamp	FOR CONSENT
Date Stamp	10.10.22
Scale	1 : 4000 (A3)
Drawing No.	310203848-01-001-G0202
Rev.	D

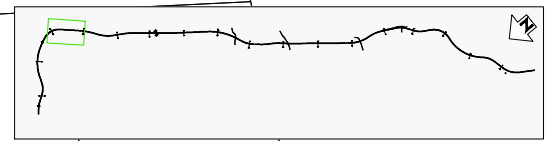

LEGEND	
	EXISTING PROPERTY BOUNDARY
	LAND TO BE DESIGNATED FOR ROAD



NOTE
ALL INFORMATION SHOWN IS SUBJECT TO FINAL DESIGN AND THE DETAILS MAY CHANGE. AREAS AND MEASUREMENTS ARE SUBJECT TO SURVEY.

NOT FOR CONSTRUCTION

REV	REVISIONS	DRN	CHK	APP	DATE
E	STANTEC REFERENCES 514 AND 516 REMOVED, DESIGNATION AND REFERENCE 134 AMENDED	SS	PP	PP	30.06.23
D	PROPERTY 221 REMOVED & DESIGNATION AMENDED	MH	JP	JP	10.22
C	ADDITIONAL PARCELS ADDED & OWNER DETAILS UPDATED	MH	JP	JP	21.09.22
B	ISSUED FOR RMA CONSENT	SS	JP	JP	19.04.22
A	ISSUED FOR CONSENT - DRAFT	SS	PP	JP	20.04.22

SURVEYED	-	-
DESIGNED	-	-
DRAWN	Steve Sutton	21.02.22
CAD REVIEW	Steve Sutton	19.04.22
DESIGN CHECK	Jamie Povall	19.04.22
DESIGN REVIEW	Phil Peet	19.04.22
APPROVED	Phil Peet	30.06.23
PROF REGISTRATION:		



Client:
WAKA KOTAHI
OTAKI TO NORTH OF LEVIN PROJECT
LAND REQUIREMENT PLAN
SHEET 4

Status Stamp	FOR CONSENT
Date Stamp	30.06.23
Scale	1 : 4000 (A3)
Drawing No.	310203848-01-001-G0203
Rev.	E

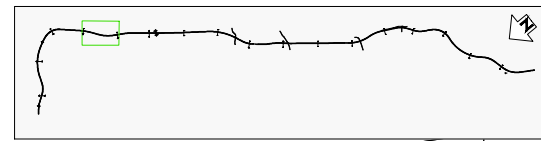

LEGEND	
	EXISTING PROPERTY BOUNDARY
	LAND TO BE DESIGNATED FOR ROAD



ARAPAEPAE RD NORTH (SH57)

QUEEN STREET EAST

NOTE
ALL INFORMATION SHOWN IS SUBJECT TO FINAL DESIGN AND THE DETAILS MAY CHANGE. AREAS AND MEASUREMENTS ARE SUBJECT TO SURVEY.

NOT FOR CONSTRUCTION

REV	DESCRIPTION	DRN	CHK	APP	DATE
E	STANTEC REFERENCES 514 AND 516 REMOVED, DESIGNATION AND REFERENCE 134 AMENDED	SS	PP	JP	30.06.23
D	PROPERTY 221 REMOVED & DESIGNATION AMENDED	MH	JP	JP	10.22
C	ADDITIONAL PARCELS ADDED & OWNER DETAILS UPDATED	MH	JP	JP	21.09.22
B	ISSUED FOR RMA CONSENT	SS	JP	JP	19.08.22
A	ISSUED FOR CONSENT - DRAFT	SS	PP	JP	20.04.22

STATUS	DATE	BY
SURVEYED	-	-
DESIGNED	-	-
DRAWN	21.02.22	Steve Sutton
CAD REVIEW	19.04.22	Steve Sutton
DESIGN CHECK	19.04.22	Jamie Povall
DESIGN REVIEW	19.04.22	Phil Peet
APPROVED	30.06.23	Phil Peet

Client:



WAKA KOTAHI
OTAKI TO NORTH OF LEVIN PROJECT

LAND REQUIREMENT PLAN
SHEET 5

Status Stamp	FOR CONSENT
Date Stamp	30.06.23
Scale	1 : 4000 (A3)
Drawing No.	310203848-01-001-G0204
Rev.	E

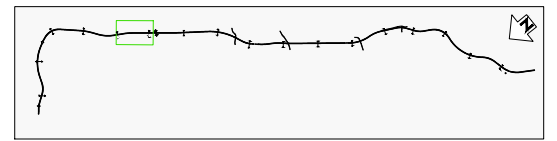

LEGEND	
	EXISTING PROPERTY BOUNDARY
	LAND TO BE DESIGNATED FOR ROAD



ARAPAEPAE RD SOUTH (SH57)

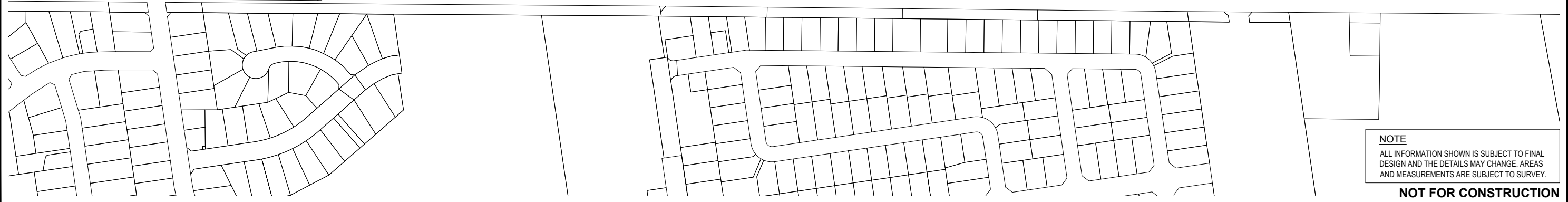

NOTE
ALL INFORMATION SHOWN IS SUBJECT TO FINAL DESIGN AND THE DETAILS MAY CHANGE. AREAS AND MEASUREMENTS ARE SUBJECT TO SURVEY.

NOT FOR CONSTRUCTION

REV	DESCRIPTION	DRN	CHK	APP	DATE
D	PROPERTY 221 REMOVED & DESIGNATION AMENDED	MH	JP	JP	10.22
C	ADDITIONAL PARCELS ADDED & OWNER DETAILS UPDATED	MH	JP	JP	21.09.22
B	ISSUED FOR RMA CONSENT	SS	JP	JP	19.08.22
A	ISSUED FOR CONSENT - DRAFT	SS	PP	JP	20.04.22

SURVEYED	-	-
DESIGNED	-	-
DRAWN	Steve Sutton	21.02.22
CAD REVIEW	Steve Sutton	19.04.22
DESIGN CHECK	Jamie Povall	19.04.22
DESIGN REVIEW	Phil Peet	19.04.22
APPROVED	Jamie Povall	10.10.22
PROF REGISTRATION:		

Client:

WAKA KOTAHI
OTAKI TO NORTH OF LEVIN PROJECT

LAND REQUIREMENT PLAN
SHEET 6

Status Stamp	FOR CONSENT
Date Stamp	10.10.22
Scale	1 : 4000 (A3)
Drawing No.	310203848-01-001-G0205
Rev.	D

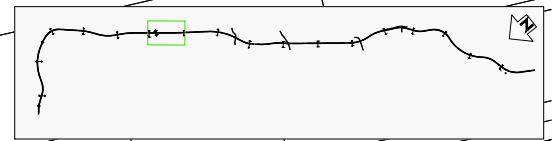

LEGEND	
	EXISTING PROPERTY BOUNDARY
	LAND TO BE DESIGNATED FOR ROAD



NOTE
 ALL INFORMATION SHOWN IS SUBJECT TO FINAL DESIGN AND THE DETAILS MAY CHANGE. AREAS AND MEASUREMENTS ARE SUBJECT TO SURVEY.

NOT FOR CONSTRUCTION

REV	REVISIONS	DRN	CHK	APP	DATE
D	PROPERTY 221 REMOVED & DESIGNATION AMENDED	MH	JP	JP	10.22
C	ADDITIONAL PARCELS ADDED & OWNER DETAILS UPDATED	MH	JP	JP	21.09.22
B	ISSUED FOR RMA CONSENT	SS	JP	JP	19.08.22
A	ISSUED FOR CONSENT - DRAFT	SS	PP	JP	20.04.22

SURVEYED	-	-
DESIGNED	-	-
DRAWN	Steve Sutton	21.02.22
CAD REVIEW	Steve Sutton	19.04.22
DESIGN CHECK	Jamie Povall	19.04.22
DESIGN REVIEW	Phil Peet	19.04.22
APPROVED	Jamie Povall	10.10.22
PROF REGISTRATION:		



Client:
WAKA KOTAHI
 OTAKI TO NORTH OF LEVIN PROJECT
 LAND REQUIREMENT PLAN
 SHEET 7

Status Stamp	FOR CONSENT
Date Stamp	10.10.22
Scale	1 : 4000 (A3)
Drawing No.	310203848-01-001-G0206
Rev.	D



LEGEND

— EXISTING PROPERTY BOUNDARY

■ LAND TO BE DESIGNATED FOR ROAD

NOTE
 ALL INFORMATION SHOWN IS SUBJECT TO FINAL DESIGN AND THE DETAILS MAY CHANGE. AREAS AND MEASUREMENTS ARE SUBJECT TO SURVEY.

NOT FOR CONSTRUCTION

REV	REVISIONS	DRN	CHK	APP	DATE
D	PROPERTY 221 REMOVED & DESIGNATION AMENDED	MH	JP	JP	10.22
C	ADDITIONAL PARCELS ADDED & OWNER DETAILS UPDATED	MH	JP	JP	21.09.22
B	ISSUED FOR RMA CONSENT	SS	JP	JP	19.08.22
A	ISSUED FOR CONSENT - DRAFT	SS	PP	JP	20.04.22

SURVEYED	DESIGNED	DRAWN	CAD REVIEW	DESIGN CHECK	DESIGN REVIEW	APPROVED	PROF REGISTRATION
-	-	Steve Sutton	Steve Sutton	Jamie Povall	Phil Peet	Jamie Povall	-
-	-	21.02.22	19.04.22	19.04.22	19.04.22	19.04.22	10.10.222



Client:
WAKA KOTAHI
 OTAKI TO NORTH OF LEVIN PROJECT
 LAND REQUIREMENT PLAN
 SHEET 8

Status Stamp	FOR CONSENT
Date Stamp	10.10.22
Scale	1 : 4000 (A3)
Drawing No.	310203848-01-001-G0207
Rev.	D



INSET SHOWING FULL EXTENT OF DESIGNATION

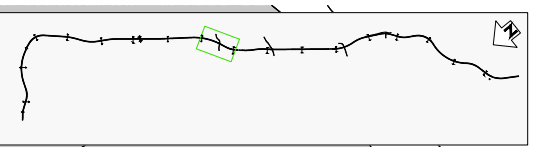

LEGEND
 ——— EXISTING PROPERTY BOUNDARY
 ■■■ LAND TO BE DESIGNATED FOR ROAD

NOTE
 ALL INFORMATION SHOWN IS SUBJECT TO FINAL DESIGN AND THE DETAILS MAY CHANGE. AREAS AND MEASUREMENTS ARE SUBJECT TO SURVEY.

NOT FOR CONSTRUCTION

REV	REVISIONS	DRN	CHK	APP	DATE
D	PROPERTY 221 REMOVED & DESIGNATION AMENDED	MH	JP	JP	10.22
C	ADDITIONAL PARCELS ADDED & OWNER DETAILS UPDATED	MH	JP	JP	21.09.22
B	ISSUED FOR RMA CONSENT	SS	JP	JP	19.08.22
A	ISSUED FOR CONSENT - DRAFT	SS	PP	JP	20.04.22

SURVEYED	DESIGNED	DRAWN	CAD REVIEW	DESIGN CHECK	DESIGN REVIEW	APPROVED
-	-	Steve Sutton	Steve Sutton	Jamie Povall	Phil Peet	Jamie Povall
-	-	21.02.22	19.04.22	19.04.22	19.04.22	10.10.22

Client:



WAKA KOTAHI
 OTAKI TO NORTH OF LEVIN PROJECT
 LAND REQUIREMENT PLAN
 SHEET 9

Status Stamp	FOR CONSENT
Date Stamp	10.10.22
Scale	1 : 4000 (A3)
Drawing No.	310203848-01-001-G0208
Rev.	D



LEGEND

— EXISTING PROPERTY BOUNDARY

■ LAND TO BE DESIGNATED FOR ROAD

NOTE
 ALL INFORMATION SHOWN IS SUBJECT TO FINAL DESIGN AND THE DETAILS MAY CHANGE. AREAS AND MEASUREMENTS ARE SUBJECT TO SURVEY.

NOT FOR CONSTRUCTION

REV	REVISIONS	DRN	CHK	APP	DATE
D	PROPERTY 221 REMOVED & DESIGNATION AMENDED	MH	JP	JP	10.22
C	ADDITIONAL PARCELS ADDED & OWNER DETAILS UPDATED	MH	JP	JP	21.09.22
B	ISSUED FOR RMA CONSENT	SS	JP	JP	19.08.22
A	ISSUED FOR CONSENT - DRAFT	SS	PP	JP	20.04.22

SURVEYED	-	-
DESIGNED	-	-
DRAWN	Steve Sutton	21.02.22
CAD REVIEW	Steve Sutton	19.04.22
DESIGN CHECK	Jamie Povall	19.04.22
DESIGN REVIEW	Phil Peet	19.04.22
APPROVED	Jamie Povall	10.10.22
PROF REGISTRATION:		



Client:
WAKA KOTAHI
 OTAKI TO NORTH OF LEVIN PROJECT
 LAND REQUIREMENT PLAN
 SHEET 10

Status Stamp	FOR CONSENT
Date Stamp	10.10.22
Scale	1 : 4000 (A3)
Drawing No.	310203848-01-001-G0209
Rev.	D

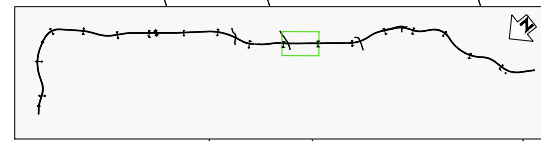

LEGEND	
	EXISTING PROPERTY BOUNDARY
	LAND TO BE DESIGNATED FOR ROAD



NOTE
 ALL INFORMATION SHOWN IS SUBJECT TO FINAL DESIGN AND THE DETAILS MAY CHANGE. AREAS AND MEASUREMENTS ARE SUBJECT TO SURVEY.

NOT FOR CONSTRUCTION

REV	REVISIONS	DRN	CHK	APP	DATE
D	PROPERTY 221 REMOVED & DESIGNATION AMENDED	MH	JP	JP	10.22
C	ADDITIONAL PARCELS ADDED & OWNER DETAILS UPDATED	MH	JP	JP	21.09.22
B	ISSUED FOR RMA CONSENT	SS	JP	JP	19.08.22
A	ISSUED FOR CONSENT - DRAFT	SS	PP	JP	20.04.22

SURVEYED	-	-
DESIGNED	-	-
DRAWN	Steve Sutton	21.02.22
CAD REVIEW	Steve Sutton	19.04.22
DESIGN CHECK	Jamie Povall	19.04.22
DESIGN REVIEW	Phil Peet	19.04.22
APPROVED	Jamie Povall	10.10.22
PROF REGISTRATION:		



Client: WAKA KOTAHI
 OTAKI TO NORTH OF LEVIN PROJECT

LAND REQUIREMENT PLAN
 SHEET 11

Status Stamp	FOR CONSENT
Date Stamp	10.10.22
Scale	1 : 4000 (A3)
Drawing No.	310203848-01-001-G0210
Rev.	D



REV	REVISIONS	DRN	CHK	APP	DATE
D	PROPERTY 221 REMOVED & DESIGNATION AMENDED	MH	JP	JP	10.22
C	ADDITIONAL PARCELS ADDED & OWNER DETAILS UPDATED	MH	JP	JP	21.09.22
B	ISSUED FOR RMA CONSENT	SS	JP	JP	19.08.22
A	ISSUED FOR CONSENT - DRAFT	SS	PP	JP	20.04.22

PROF REGISTRATION:	DATE	BY	DATE	BY
SURVEYED	-	-	-	-
DESIGNED	-	-	-	-
DRAWN	21.02.22	Steve Sutton	19.04.22	Steve Sutton
CAD REVIEW	19.04.22	Steve Sutton	19.04.22	Jamie Povall
DESIGN CHECK	19.04.22	Jamie Povall	19.04.22	Phil Peet
DESIGN REVIEW	19.04.22	Phil Peet	19.04.22	Jamie Povall
APPROVED	10.10.22	Jamie Povall		



Client: WAKA KOTAHI
 OTAKI TO NORTH OF LEVIN PROJECT
 LAND REQUIREMENT PLAN
 SHEET 12

Status Stamp	FOR CONSENT
Date Stamp	10.10.22
Scale	1 : 4000 (A3)
Drawing No.	310203848-01-001-G0211
Rev.	D

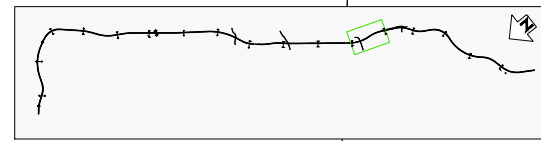

LEGEND	
	EXISTING PROPERTY BOUNDARY
	LAND TO BE DESIGNATED FOR ROAD

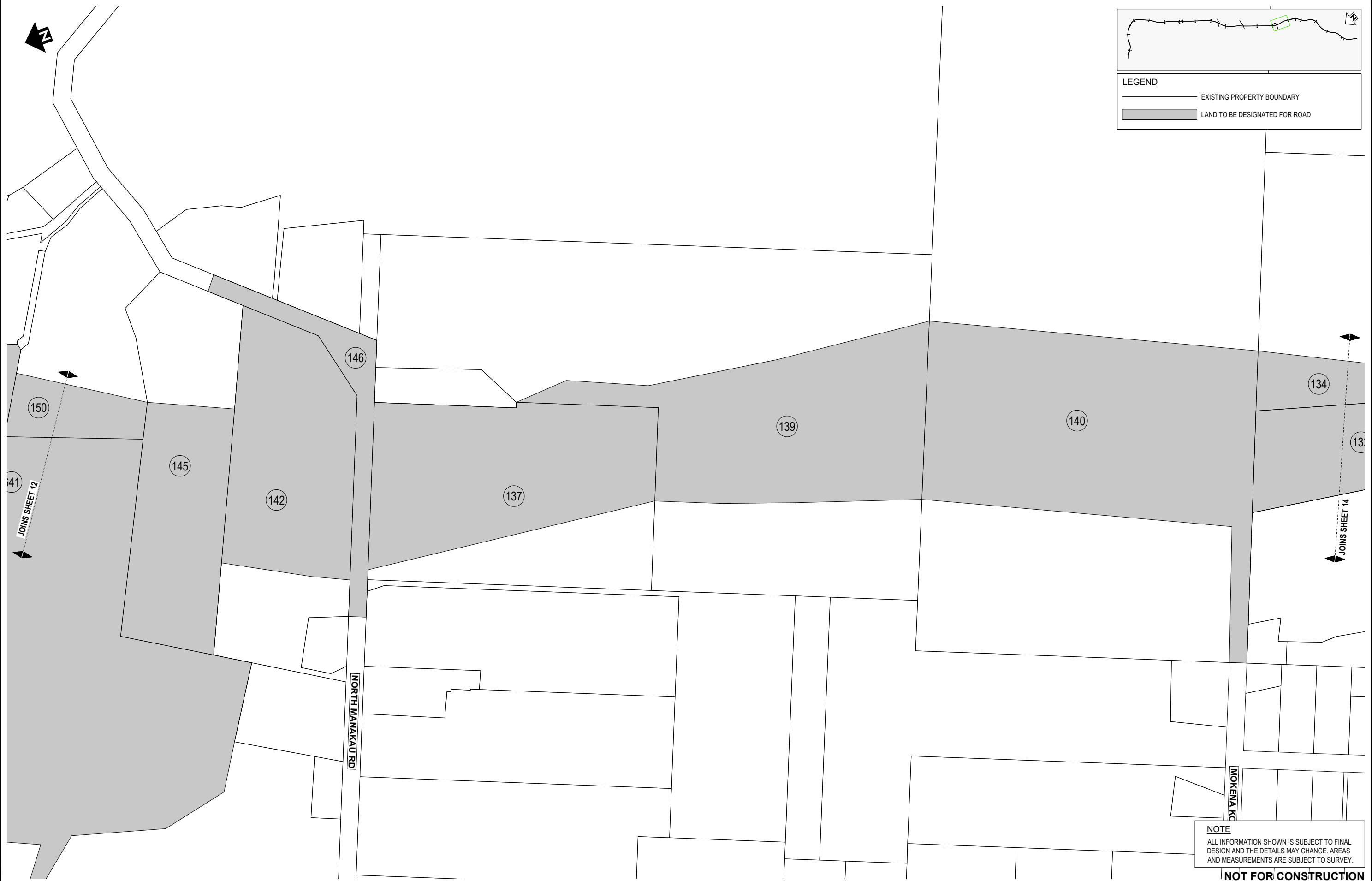

NOTE
ALL INFORMATION SHOWN IS SUBJECT TO FINAL DESIGN AND THE DETAILS MAY CHANGE. AREAS AND MEASUREMENTS ARE SUBJECT TO SURVEY.

NOT FOR CONSTRUCTION

REV	REVISIONS	DRN	CHK	APP	DATE
D	PROPERTY 221 REMOVED & DESIGNATION AMENDED	MH	JP	JP	10.22
C	ADDITIONAL PARCELS ADDED & OWNER DETAILS UPDATED	MH	JP	JP	21.09.22
B	ISSUED FOR RMA CONSENT	SS	JP	JP	19.08.22
A	ISSUED FOR CONSENT - DRAFT	SS	PP	JP	20.04.22

SURVEYED	DESIGNED	DRAWN	CAD REVIEW	DESIGN CHECK	DESIGN REVIEW	APPROVED	PROF REGISTRATION
-	-	Steve Sutton	Steve Sutton	Jamie Povall	Phil Peet	Jamie Povall	
		21.02.22	19.04.22	19.04.22	19.04.22	19.04.22	10.10.222



Client: **WAKA KOTAHI**
OTAKI TO NORTH OF LEVIN PROJECT

LAND REQUIREMENT PLAN
SHEET 13

Status Stamp	FOR CONSENT
Date Stamp	10.10.22
Scale	1 : 4000 (A3)
Drawing No.	310203848-01-001-G0212
Rev.	D

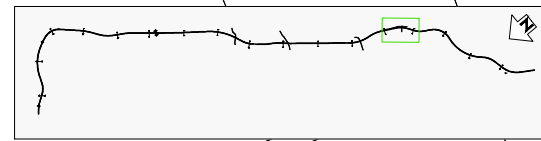

LEGEND	
	EXISTING PROPERTY BOUNDARY
	LAND TO BE DESIGNATED FOR ROAD



NOTE
ALL INFORMATION SHOWN IS SUBJECT TO FINAL DESIGN AND THE DETAILS MAY CHANGE. AREAS AND MEASUREMENTS ARE SUBJECT TO SURVEY.

NOT FOR CONSTRUCTION

REV	DESCRIPTION	DRN	CHK	APP	DATE
E	STANTEC REFERENCES 514 AND 516 REMOVED, DESIGNATION AND REFERENCE 134 AMENDED	SS	PP	PP	30.06.23
D	PROPERTY 221 REMOVED & DESIGNATION AMENDED	MH	JP	JP	10.22
C	ADDITIONAL PARCELS ADDED & OWNER DETAILS UPDATED	MH	JP	JP	21.09.22
B	ISSUED FOR RMA CONSENT	SS	JP	JP	19.04.22
A	ISSUED FOR CONSENT - DRAFT	SS	PP	JP	20.04.22

SURVEYED		
DESIGNED	-	-
DRAWN	Steve Sutton	21.02.22
CAD REVIEW	Steve Sutton	19.04.22
DESIGN CHECK	Jamie Poval	19.04.22
DESIGN REVIEW	Phil Peet	19.04.22
APPROVED	Phil Peet	30.06.23
PROF REGISTRATION:		

Client:



WAKA KOTAHI
OTAKI TO NORTH OF LEVIN PROJECT

LAND REQUIREMENT PLAN
SHEET 14

Status Stamp	FOR CONSENT
Date Stamp	30.06.23
Scale	1 : 4000 (A3)
Drawing No.	310203848-01-001-G0213
Rev.	E



LEGEND

	EXISTING PROPERTY BOUNDARY
	LAND TO BE DESIGNATED FOR ROAD

NOTE
 ALL INFORMATION SHOWN IS SUBJECT TO FINAL DESIGN AND THE DETAILS MAY CHANGE. AREAS AND MEASUREMENTS ARE SUBJECT TO SURVEY.

NOT FOR CONSTRUCTION

REV	REVISIONS	DRN	CHK	APP	DATE
D	PROPERTY 221 REMOVED & DESIGNATION AMENDED	MH	JP	JP	10.22
C	ADDITIONAL PARCELS ADDED & OWNER DETAILS UPDATED	MH	JP	JP	21.09.22
B	ISSUED FOR RMA CONSENT	SS	JP	JP	19.08.22
A	ISSUED FOR CONSENT - DRAFT	SS	PP	JP	20.04.22

SURVEYED	DESIGNED	DRAWN	CAD REVIEW	DESIGN CHECK	DESIGN REVIEW	APPROVED
-	-	Steve Sutton	Steve Sutton	Jamie Povall	Phil Peet	Jamie Povall
-	-	21.02.22	19.04.22	19.04.22	19.04.22	10.10.22

Client:

WAKA KOTAHI
 OTAKI TO NORTH OF LEVIN PROJECT

LAND REQUIREMENT PLAN
 SHEET 15

Status Stamp	FOR CONSENT
Date Stamp	10.10.22
Scale	1 : 4000 (A3)
Drawing No.	310203848-01-001-G0214
Rev.	D



HOROWHENUA DISTRICT
 HORIZONS REGIONAL COUNCIL
 KAPITI COAST DISTRICT
 GREATER WELLINGTON
 REGIONAL COUNCIL

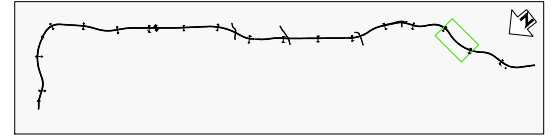

LEGEND

— EXISTING PROPERTY BOUNDARY

■ LAND TO BE DESIGNATED FOR ROAD

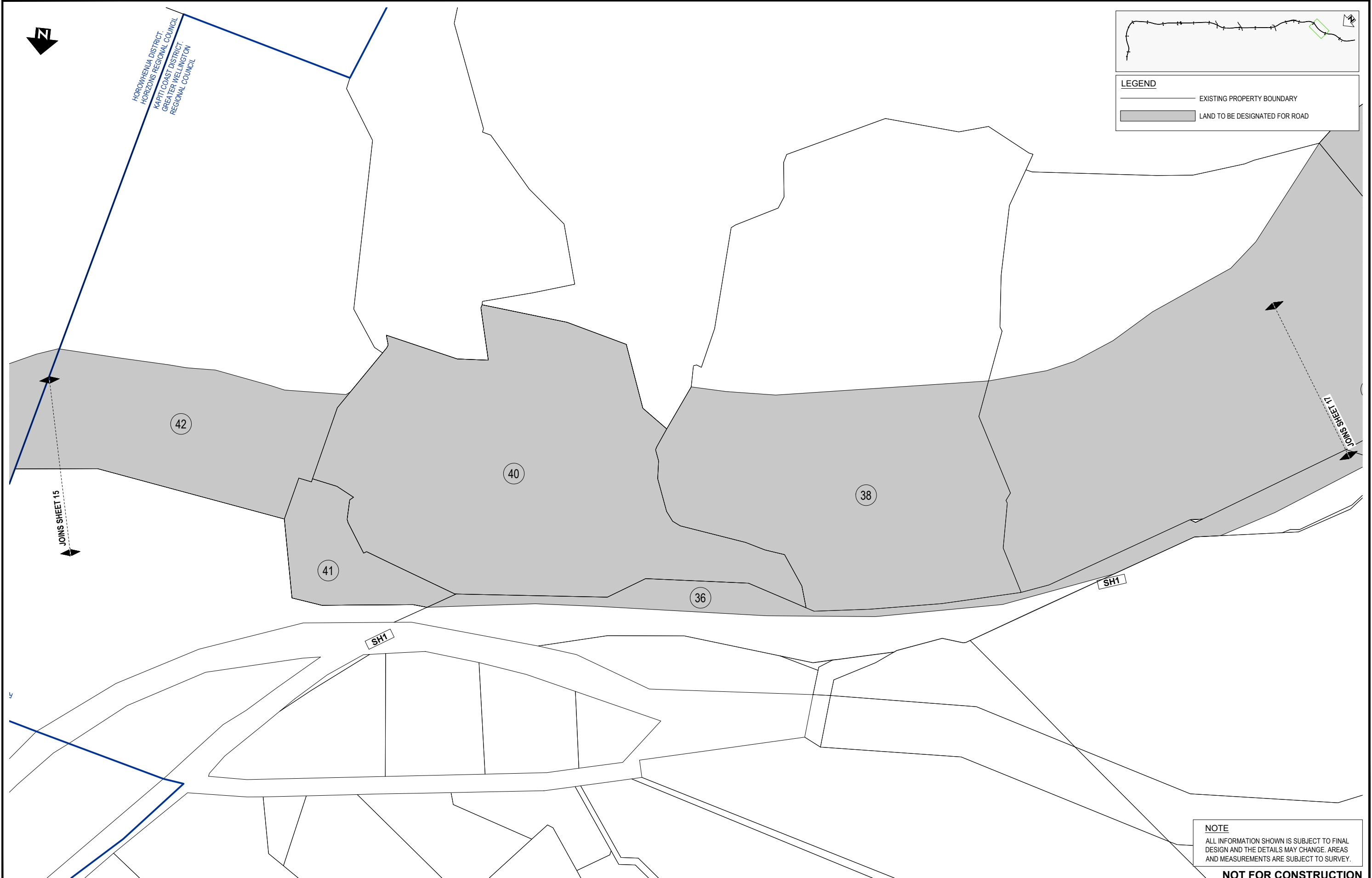

NOTE
 ALL INFORMATION SHOWN IS SUBJECT TO FINAL DESIGN AND THE DETAILS MAY CHANGE. AREAS AND MEASUREMENTS ARE SUBJECT TO SURVEY.

NOT FOR CONSTRUCTION

REV	REVISIONS	DRN	CHK	APP	DATE
D	PROPERTY 221 REMOVED & DESIGNATION AMENDED	MH	JP	JP	10.22
C	ADDITIONAL PARCELS ADDED & OWNER DETAILS UPDATED	MH	JP	JP	21.09.22
B	ISSUED FOR RMA CONSENT	SS	JP	JP	19.08.22
A	ISSUED FOR CONSENT - DRAFT	SS	PP	JP	20.04.22

SURVEYED	DESIGNED	DRAWN	CAD REVIEW	DESIGN CHECK	DESIGN REVIEW	APPROVED
-	-	Steve Sutton	Steve Sutton	Jamie Povall	Phil Peet	Jamie Povall
-	-	21.02.22	19.04.22	19.04.22	19.04.22	10.10.22



Client:
WAKA KOTAHI
 NZ TRANSPORT AGENCY

WAKA KOTAHI
 OTAKI TO NORTH OF LEVIN PROJECT

LAND REQUIREMENT PLAN
 SHEET 16

Status Stamp	FOR CONSENT
Date Stamp	10.10.22
Scale	1 : 4000 (A3)
Drawing No.	310203848-01-001-G0215
Rev.	D

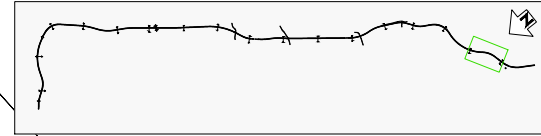

LEGEND	
	EXISTING PROPERTY BOUNDARY
	LAND TO BE DESIGNATED FOR ROAD



NOTE
 ALL INFORMATION SHOWN IS SUBJECT TO FINAL DESIGN AND THE DETAILS MAY CHANGE. AREAS AND MEASUREMENTS ARE SUBJECT TO SURVEY.

NOT FOR CONSTRUCTION

REV	DESCRIPTION	DRN	CHK	APP	DATE
D	PROPERTY 221 REMOVED & DESIGNATION AMENDED	MH	JP	JP	10.22
C	ADDITIONAL PARCELS ADDED & OWNER DETAILS UPDATED	MH	JP	JP	21.09.22
B	ISSUED FOR RMA CONSENT	SS	JP	JP	19.08.22
A	ISSUED FOR CONSENT - DRAFT	SS	PP	JP	20.04.22

SURVEYED	-	-
DESIGNED	-	-
DRAWN	Steve Sutton	21.02.22
CAD REVIEW	Steve Sutton	19.04.22
DESIGN CHECK	Jamie Povall	19.04.22
DESIGN REVIEW	Phil Peet	19.04.22
APPROVED	Jamie Povall	10.10.22
PROF REGISTRATION:		



Client:
WAKA KOTAHI
 NZ TRANSPORT AGENCY

WAKA KOTAHI
 OTAKI TO NORTH OF LEVIN PROJECT

LAND REQUIREMENT PLAN
 SHEET 17

Status Stamp	FOR CONSENT
Date Stamp	10.10.22
Scale	1 : 4000 (A3)
Drawing No.	310203848-01-001-G0216
Rev.	D



LEGEND

— EXISTING PROPERTY BOUNDARY

■ LAND TO BE DESIGNATED FOR ROAD



NOTE
ALL INFORMATION SHOWN IS SUBJECT TO FINAL DESIGN AND THE DETAILS MAY CHANGE. AREAS AND MEASUREMENTS ARE SUBJECT TO SURVEY.

NOT FOR CONSTRUCTION

REV	DESCRIPTION	DRN	CHK	APP	DATE
D	PROPERTY 221 REMOVED & DESIGNATION AMENDED	MH	JP	JP	10.22
C	ADDITIONAL PARCELS ADDED & OWNER DETAILS UPDATED	MH	JP	JP	21.09.22
B	ISSUED FOR RMA CONSENT	SS	JP	JP	19.08.22
A	ISSUED FOR CONSENT - DRAFT	SS	PP	JP	20.04.22

SURVEYED	-	-
DESIGNED	-	-
DRAWN	Steve Sutton	21.02.22
CAD REVIEW	Steve Sutton	19.04.22
DESIGN CHECK	Jamie Poval	19.04.22
DESIGN REVIEW	Phil Peet	19.04.22
APPROVED	Jamie Poval	10.10.22
PROF REGISTRATION:		

Client:



WAKA KOTAHI
OTAKI TO NORTH OF LEVIN PROJECT

LAND REQUIREMENT PLAN
SHEET 18

Status Stamp	FOR CONSENT
Date Stamp	10.10.22
Scale	1 : 4000 (A3)
Drawing No.	310203848-01-001-G0217
Rev.	D

Stantec Reference	Title Reference	Legal Description	Parcel ID	Ownership	Council	AREA OF LAND (Ha)			Stantec Reference	Title Reference	Legal Description	Parcel ID	Ownership	Council	AREA OF LAND (Ha)		
548	WN40C/78	Lot 2 DP 73153	3824064	Alistair Bruce Haig	Horowhenua District Council	3.3704	2.095	5.466	680	377784	Lot 4 DP 394488	7012920	Her Majesty the Queen	Horowhenua District Council	0.925	0.000	0.925
550	540593	Lot 1 DP 438115	7299228	Lisa Jane Wildbore, Robin Francis Wildbore, Todd Whitehouse Trustees Limited	Horowhenua District Council	1.069	6.987	8.056	1009	799612	Lot 2 DP 514857	7812630	Christopher Grant Bly, Jocasta Delle Bly	Horowhenua District Council	0.2137	0.295	0.509
555	WNF2/1350	Lot 21 DP 2291	3939745	Ewen Malcolm Vile, Faye Lexia Vautier	Horowhenua District Council	2.124	0.000	2.124	1034		Part Lot 5 DP 872	4050494	Road	Horowhenua District Council	0.168	0.000	0.168
560	WN55D/113	Lot 1 DP 88246	3780224	Graeme John Gouldsmith	Horowhenua District Council	1.6901	1.906	3.596	1035			4097098	Road	Kapiti Coast District Council	0.15	0.108	0.258
561	WNF2/1351	Lot 22 DP 2291	3747364	Her Majesty The Queen	Horowhenua District Council	1.3704	0.754	2.124	1036			4093769	Road	Horowhenua District Council	0.020	0.000	0.020
565	423307	Lot 2 DP 406641	7088748	ARL Tompson Trust Limited, Michael George Tompson	Horowhenua District Council	0.5739	1.990	2.564	1037			4091277	Road	Horowhenua District Council	0.328	0.000	0.328
566	WNF2/1352	Lot 23 DP 2291	3933006	Heather Joy Drummond, Murray Robert Drummond, Todd Whitehouse Trustees (2017) Limited	Horowhenua District Council	1.2792	0.845	2.124	1038	WN36A/477	Section 1 SO 24047	7352484	Chorus New Zealand Limited	Kapiti Coast District Council	0.019	0.000	0.019
569	WN955/93	Lot 2 DP 21965	3761761	Cindy Susan Pender, David Lawson James Elder	Horowhenua District Council	0.3726	1.752	2.125	4146	888014	Lot 1 DP 535861	7981821	Her Majesty the Queen	Horowhenua District Council	1.2023	5.587	6.789
570	WNF2/764	Lot 24 DP 2291	3772361	Jeanette Heather Wilson	Horowhenua District Council	1.1997	0.925	2.124									
573	WN44D/213	Part Lot 1 DP 29766	3765431	Her Majesty The Queen	Horowhenua District Council	3.1179	0.532	3.650									
574	512963	Lot 2 DP 428802	7244492	Jennifer Ann Horn, Ronald William Horn	Horowhenua District Council	1.6692	5.694	7.364									
576			4077511	Road	Horowhenua District Council	0.6091	0.237	0.8465									
577	385893	Lot 2 DP 396758	7025789	Carol Dorothy Bloomfield, Errol Alexander Macdonald, Robert James Bloomfield	Horowhenua District Council	7.5688	4.310	11.878									
580			4086907	Road	Horowhenua District Council	1.7003	0.643	2.3436									
582	385892	Lot 1 DP 396758	7025788	Ethan Michael Eddie Yeow, Lauren Jessica Cocks	Horowhenua District Council	0.504	0.000	0.504									
583	WN43C/180	Lot 2 DP 77284	3995964	Cullinane Steele Trustees (2020) Limited, Robin George Croot, Wendy Therese Croot	Horowhenua District Council	1.1648	4.794	5.959									
586	WNF3/275	Lot 26 DP 2291	3979554	Her Majesty the Queen	Horowhenua District Council	2.289	0.000	2.289									
587	WN38D/58	Lot 1 DP 69273	4064077	DC & SK Sue Limited	Horowhenua District Council	0.1003	4.400	4.500									
590	WN56C/965	Lot 1 DP 89255	3964005	George Stuart Toomer	Horowhenua District Council	0.4374	2.617	3.054									
591			4094590	Road	Horowhenua District Council	0.362	0.000	0.362									
592	WN11D/1284	Section 51 Block II Waiopahu SD	3842001	Carol Dorothy Bloomfield, Errol Alexander Macdonald, Robert James Bloomfield	Horowhenua District Council	9.148	3.208	12.356									
594	WN56C/911	Lot 1 DP 89230	3835824	Her Majesty The Queen	Horowhenua District Council	2.847	0.000	2.847									
596	WN24A/617	Lot 1 DP 52953	3902849	Lynette Florence MacKay, Tania Jean MacKay	Horowhenua District Council	0.207	0.000	0.207									
598	WN53C/388	Lot 1 DP 85775	3902848	Joycelyn Te Ata Emma Evans, Tony Kenneth Evans	Horowhenua District Council	0.206	0.000	0.206									
599	WN38D/60	Lot 3 DP 69273	3858132	Carl Gordon Beissel, Linda Jane Beissel	Horowhenua District Council	2.1921	2.313	4.505									
600	292208	Part Lot 1 DP 372252	7076810	Carol Dorothy Bloomfield, Errol Alexander Macdonald, Robert James Bloomfield	Horowhenua District Council	0.5396	8.868	9.408									
602	WN56C/966	Lot 2 DP 89255	3965668	Her Majesty the Queen	Horowhenua District Council	1.089	0.000	1.089									
604	WN56C/967	Lot 3 DP 89255	3962459	Her Majesty the Queen	Horowhenua District Council	3.9836	0.060	4.043									
605	WN53C/389	Part Lot 2 DP 52953	3785119	Burnell Holdings Limited	Horowhenua District Council	5.378	0.000	5.378									
606	WN16B/1498	Lot 16 DP 2291	4002811	Burnell Holdings Limited	Horowhenua District Council	0.4229	4.615	5.038									
607			4071121	Road	Horowhenua District Council	1.0359	0.545	1.5807									
613			4076139	Road	Horowhenua District Council	0.7539	3.660	4.4139									
615	WN18C/863	Lot 2 DP 47003	4000960	John Alexander Fluker, John Alexander Pescini	Horowhenua District Council	0.8071	9.302	10.109									
619	WN38D/61	Lot 4 DP 69273	3945648	Her Majesty The Queen	Horowhenua District Council	0.311	0.000	0.311									
641	256150	Lot 2 DP 362812	6823683	Gary Dynel Holland, Leisa Kerine Holland	Horowhenua District Council	17.3654	7.676	25.041									
658	921237	Section 1 SO 489585	7626752	Her Majesty the Queen	Kapiti Coast District Council	0.390	0.000	0.390									
660	793067	Lot 3 DP 513294	7828363	Her Majesty The Queen	Horowhenua District Council	1.709	0.000	1.709									

NOT FOR CONSTRUCTION

B PROPERTY 221 REMOVED & DESIGNATION AMENDED A ISSUED FOR RMA CONSENT REV REVISIONS	MH	JP	JP	10.10.22	SURVEYED DESIGNED DRAWN CAD REVIEW DESIGN CHECK DESIGN REVIEW APPROVED PROF REGISTRATION:	 	Client: WAKA KOTAHI OTAKI TO NORTH OF LEVIN PROJECT LAND REQUIREMENT SCHEDULE SHEET 4	Status Stamp FOR CONSENT Date Stamp 10.10.22 Scale: AS SHOWN Drawing No. 310203848-01-001-G0223	Rev. B
	MH	JP	JP	16.08.22					