

IMPROVING OUR ROADS - CROMWELL ROUNDABOUTS

- TRAFFIC UPDATE *(February 2022)*

Work on new Cromwell highway roundabouts underway

Until the end of May from near the 'Big Fruit' sign and the Queenstown/Wanaka intersection look out for construction work on Cromwell's two new highway roundabouts.

One is being built at the SH6-SH8 intersection and another on SH8B near Barry Avenue for the Wooing Tree Estate. This roundabout is fully funded by the developer.

These roundabouts will improve safety and reduce crashes especially at the SH6-SH8B intersection.

Important information for Heavy Vehicle Operators

This detour is approved for all vehicle types (including 50Max, HPMV, Overweight & *Over dimension)

**Operators of over dimension vehicles must contact Fulton Hogan's Site Manager, Andy Dennison (0272 753 767, Andrew.Dennison@fultonhogan.com) at least 24 hours prior to travel.*

What to expect over the next four months

Timing of works:

- 1st Stage - from 8 February to end of May 2022. Usually Monday to Friday (with some Saturday work), between 7am and 7pm.
- Final stage (From June to Nov 22) – complete pedestrian underpass, final road surfacing and landscaping

Location of works: At the intersection of SH6 and SH8B, continuing along SH8B towards Deadman's Point Bridge – see map overleaf

Type of work: Earthmoving, road construction, road surfacing, pedestrian underpass construction, landscaping

Impact of work: There is likely to be intermittent noise and vibration during these works. We will work directly with any residents or businesses that could experience greater levels of disruption

Road diversions/changes to traffic layout:

There will be changes to traffic moving to and from Cromwell Town Centre and past the 'Big Fruit' sign during construction works. These changes will be in place for the full duration of the 1st stage (from February to May).

- **Queenstown and Wanaka people going into Cromwell Town, Alexandra/ Dunedin or Christchurch** - Follow the detour signs via Shortcut Road (see map)
- **Cromwell people going to Queenstown or Wanaka** - Head along SH8B, past the Big Fruit as you would usually do (i.e. no change)
- **People on SH6 travelling in either direction but not into Cromwell** - SH6 is open in both directions, no detour.
- **Left turn only when exiting Sargood Rd and Barry Ave onto SH8B**

We will advise traffic management for the final stage in future updates.

We appreciate these works will be disruptive. Please allow extra time when travelling through this area.

Any questions?

For more information, visit: <https://www.nzta.govt.nz/projects/sh6-sh8b-cromwell-intersection-improvements/> To get in touch with our team, email: cromwellroundabouts@nzta.govt.nz or call 0272 903 665.

Thank you for your understanding and patience as we work hard to construct these roundabouts.

IMPROVING OUR ROADS - CROMWELL ROUNDABOUTS

- TRAFFIC UPDATE (February 2022)

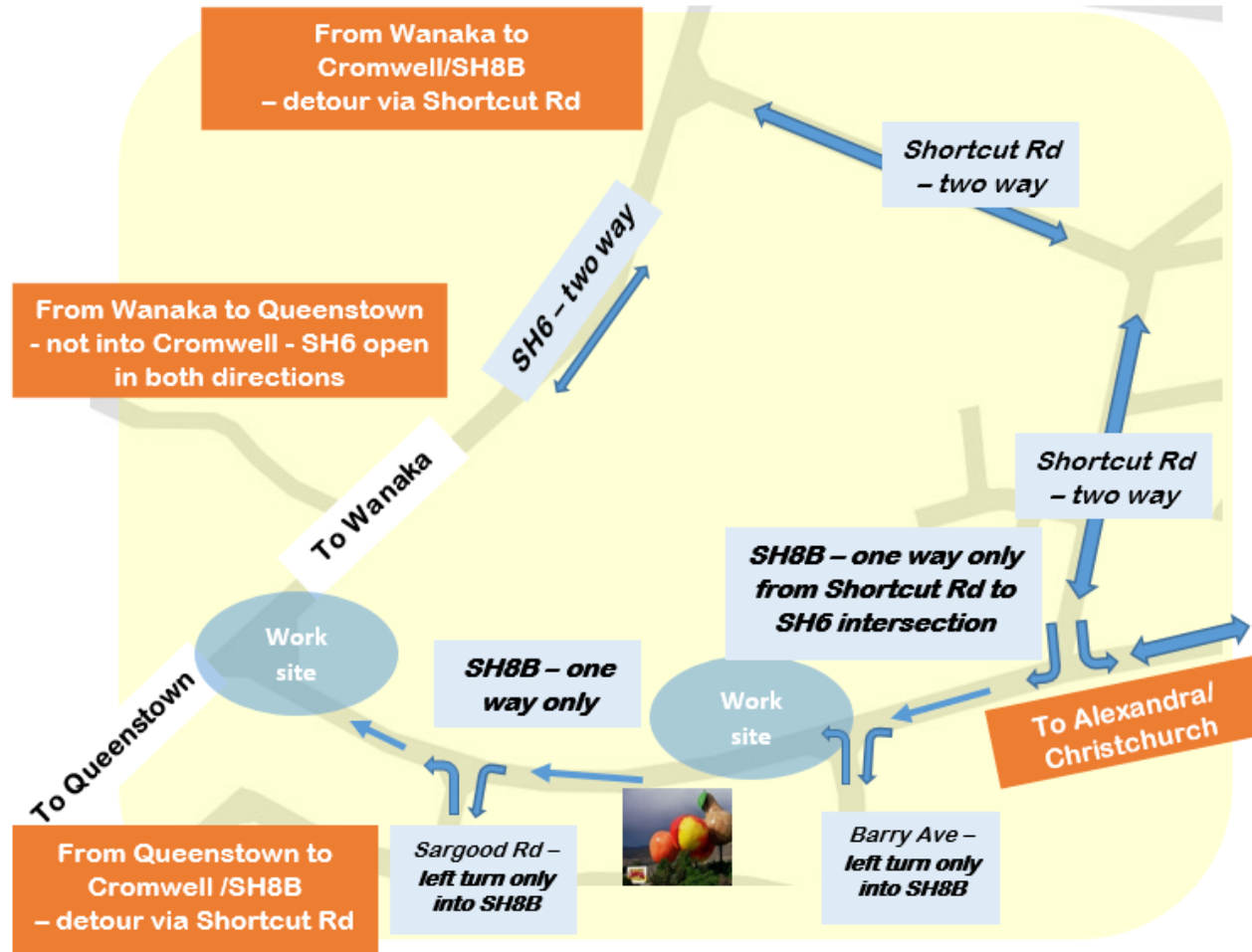

Modified traffic layout during roundabout construction works