

SOUTHERN MOTORWAY EXTENSION - STAGE 2 PROPERTY DETAILS

PROPERTY ACQUISITION REFERENCE	OWNER	ADDRESS	LEGAL DESCRIPTION	TITLE REFERENCE	AREA m <sup>2</sup>	
					REQUIRED FOR MOTORWAY	SEVERANCE
29	KEVIN LAWRENCE WILLIAMS BONNIE ANN WILLIAMS	98 MARSHES ROAD	RS 2705	CB9A/792	(29a) 24155m <sup>2</sup>	(29b) 13682m <sup>2</sup>
32	CHELANDRY FARMS LIMITED	SHANDS ROAD	LOT 2, DP 310929	43003.00	(32a) 21351m <sup>2</sup>	(32b) 4793m <sup>2</sup>
33	KEVIN LAWRENCE WILLIAMS BONNIE ANN WILLIAMS	150 MARSHS	LOT 1, DP 54254	CB31K/1089	(33a) 127888m <sup>2</sup>	(33b) 6650m <sup>2</sup>

LEGEND	
	EXISTING BOUNDARIES
	PROPOSED INDICATIVE DESIGNATION
	PROPOSED LAND AREA REQUIRED
	SEVERANCE LAND AREA

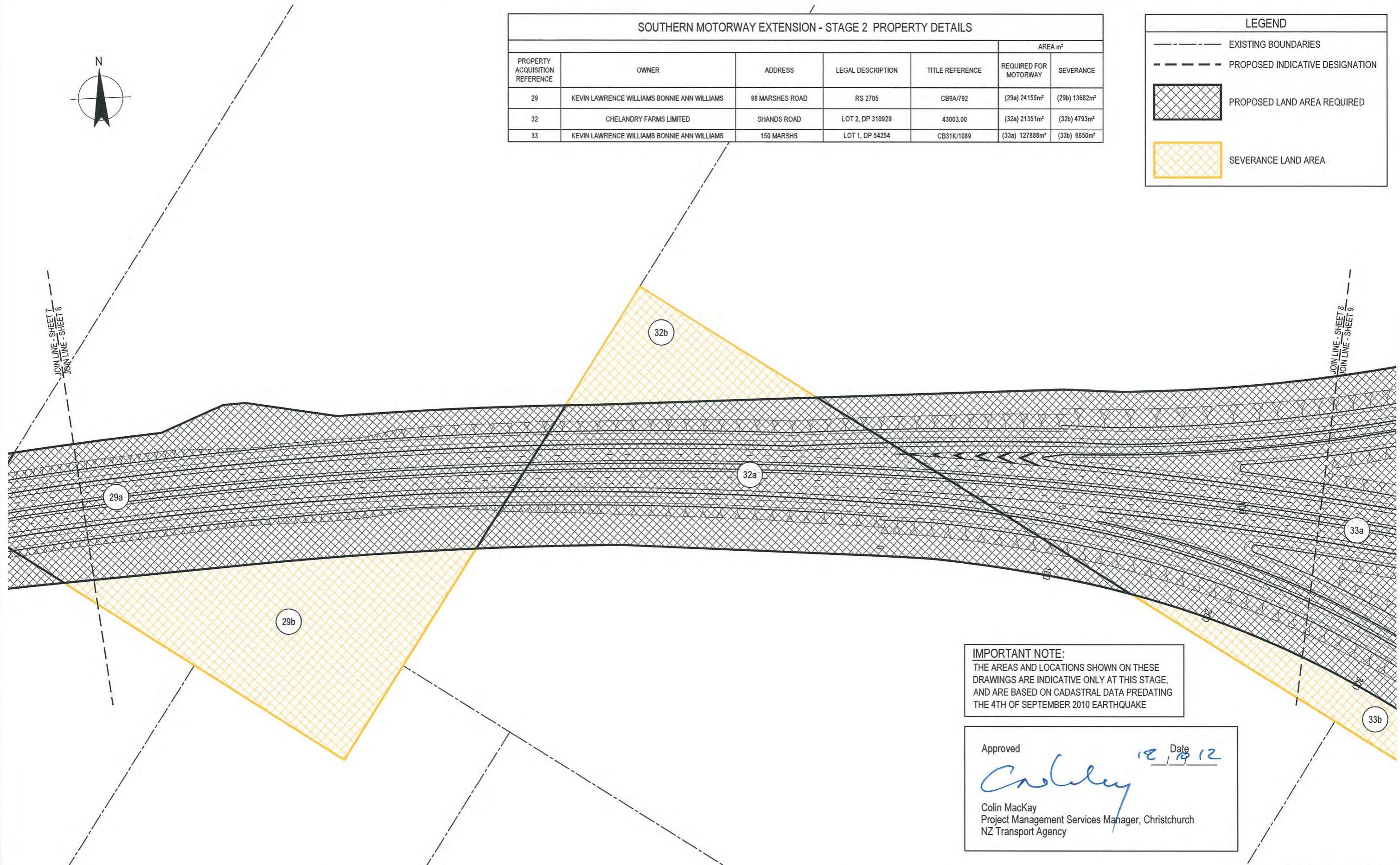

**IMPORTANT NOTE:**  
 THE AREAS AND LOCATIONS SHOWN ON THESE DRAWINGS ARE INDICATIVE ONLY AT THIS STAGE, AND ARE BASED ON CADASTRAL DATA PREDATING THE 4TH OF SEPTEMBER 2010 EARTHQUAKE

Approved  Date 12/08/12  
 Colin MacKay  
 Project Management Services Manager, Christchurch  
 NZ Transport Agency

**FOR CONSENT**

No	Revision	Note	Drawn	Checked	Approved	Date
0	FOR CONSENT		AF	DGA	GAP	29.08.12
B	FOR INFORMATION		CMD	DGA	CG	01.05.12
A	FOR INFORMATION		CMcG	DGA	CG	14.10.11



DO NOT SCALE	
Drawn	CMcG
Designed	JAS
Drafting Check	JAS
Design Check	DGA
Approved	GARY PAYNE
Date	29.08.12
A1 Scale	
A3 Scale	1:2000

Client	NEW ZEALAND TRANSPORT AGENCY
Project	SH1 REGION 11 RP350/3.92 TO RP365/2.11
Title	CHRISTCHURCH SOUTHERN MOTORWAY 2 LAND REQUIREMENT PLAN - SHEET 8 OF 18
Drawing No:	62236-B-C1108
Rev:	0

SOUTHERN MOTORWAY EXTENSION - STAGE 2 PROPERTY DETAILS

PROPERTY ACQUISITION REFERENCE	OWNER	ADDRESS	LEGAL DESCRIPTION	TITLE REFERENCE	AREA m <sup>2</sup>	
					REQUIRED FOR MOTORWAY	SEVERANCE
33	KEVIN LAWRENCE WILLIAMS BONNIE ANN WILLIAMS	150 MARSHS	LOT 1, DP 54254	CB31K/1089	(33a) 127888m <sup>2</sup>	(33b) 6650m <sup>2</sup>
34	TEGEL FOODS LIMITED	516/518 SHANDS ROAD	LOT 1, DP 53738	CB31F/593	(34a) 24085m <sup>2</sup>	(34b) 4290m <sup>2</sup>
38	FODDERCUBE PRODUCTS NTH CANTY LIMITED	SHANDS ROAD	LOT 2, DP 24365	CB8K/984	24149m <sup>2</sup>	
39	BENJAMIN WILLIAM MCALPINE TOTHILL SALLY JEAN TOTHILL	246 MARSHS AND 493 SHANDS ROAD	LOT 1, DP 24365	CB12B/1289	84741m <sup>2</sup>	

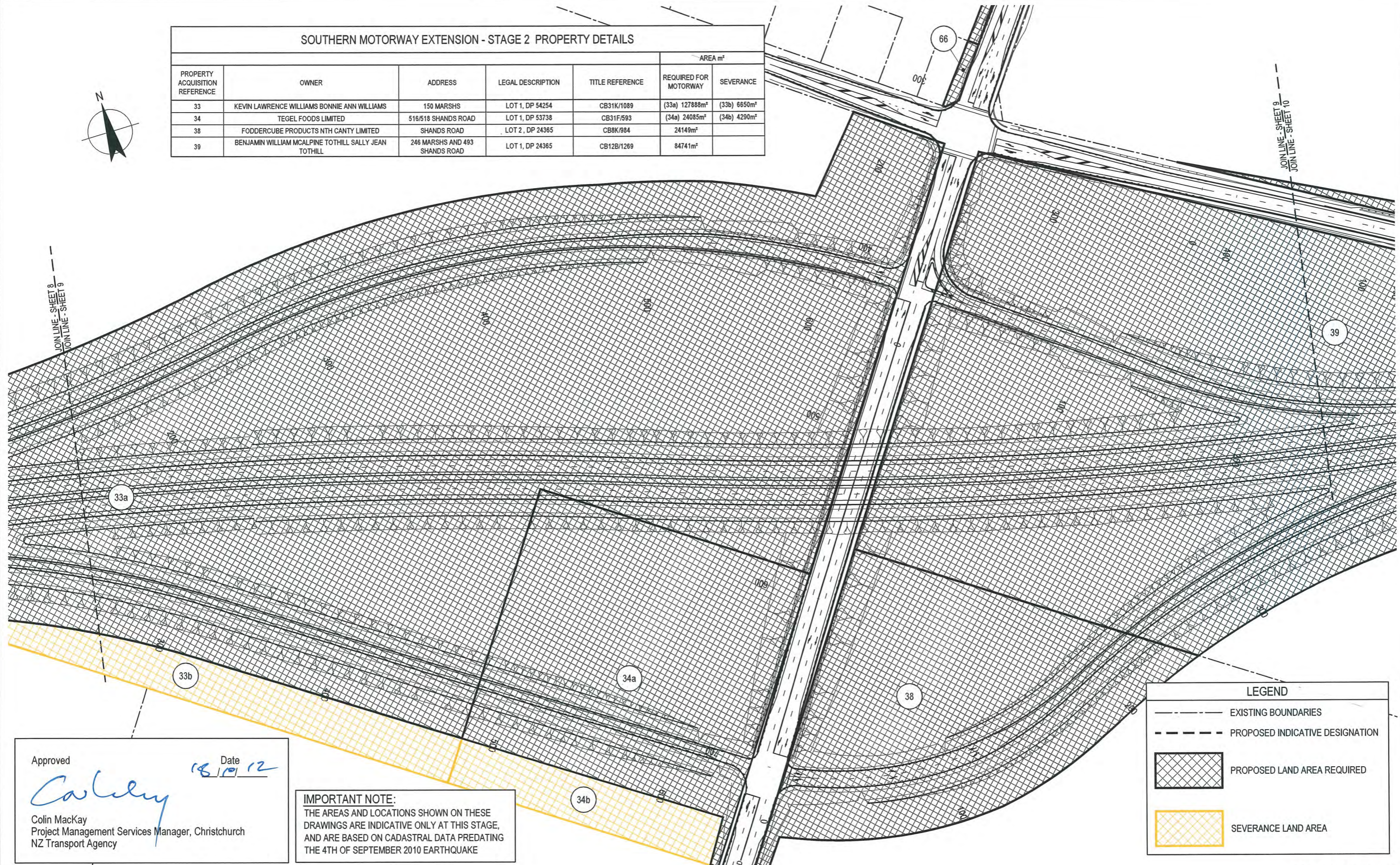

JOIN LINE - SHEET 8  
JOIN LINE - SHEET 9

JOIN LINE - SHEET 9  
JOIN LINE - SHEET 10

LEGEND	
	EXISTING BOUNDARIES
	PROPOSED INDICATIVE DESIGNATION
	PROPOSED LAND AREA REQUIRED
	SEVERANCE LAND AREA

Approved  
*Colin MacKay*  
Colin MacKay  
Project Management Services Manager, Christchurch  
NZ Transport Agency

Date 18/10/12

**IMPORTANT NOTE:**  
THE AREAS AND LOCATIONS SHOWN ON THESE DRAWINGS ARE INDICATIVE ONLY AT THIS STAGE, AND ARE BASED ON CADASTRAL DATA PREDATING THE 4TH OF SEPTEMBER 2010 EARTHQUAKE

**FOR CONSENT**

No	Revision	Note	Drawn	Checked	Approved	Date
0	FOR CONSENT		AF	DGA	GAP	29.08.12
B	FOR INFORMATION		CMD	DGA	CG	01.05.12
A	FOR INFORMATION		CMcG	DGA	CG	14.10.11



DO NOT SCALE	
Drawn CMcG	Designed JAS
Drafting Check JAS	Design Check DGA
Approved GARY PAYNE	
Date 29.08.12	
A1 Scale	This Drawing must not be used for Construction unless signed as Approved
A3 Scale 1:2000	

Client	NEW ZEALAND TRANSPORT AGENCY
Project	SH1 REGION 11 RP350/3.92 TO RP365/2.11
Title	CHRISTCHURCH SOUTHERN MOTORWAY STAGE 2 LAND REQUIREMENT PLAN - SHEET 9 OF 18
Drawing No:	62236-B-C1109
Rev:	0



JOIN LINE - SHEET 9  
JOIN LINE - SHEET 10

**IMPORTANT NOTE:**  
THE AREAS AND LOCATIONS SHOWN ON THESE DRAWINGS ARE INDICATIVE ONLY AT THIS STAGE, AND ARE BASED ON CADASTRAL DATA PREDATING THE 4TH OF SEPTEMBER 2010 EARTHQUAKE

Approved  
*Colin MacKay*  
Date 18/10/12  
Colin MacKay  
Project Management Services Manager, Christchurch  
NZ Transport Agency

**LEGEND**

- EXISTING BOUNDARIES
- - - PROPOSED INDICATIVE DESIGNATION
- [Cross-hatched box] PROPOSED LAND AREA REQUIRED
- [Yellow cross-hatched box] SEVERANCE LAND AREA

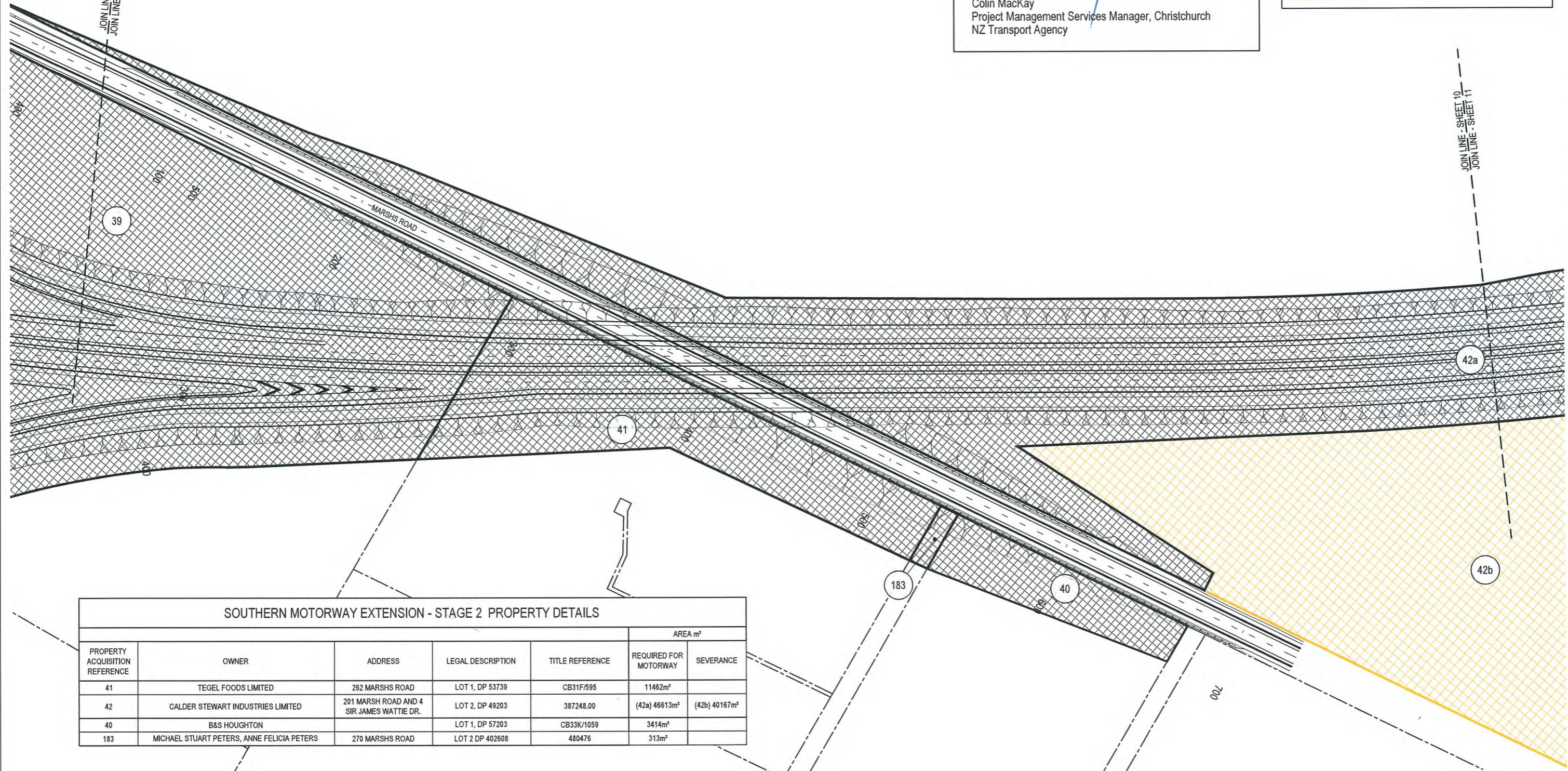

SOUTHERN MOTORWAY EXTENSION - STAGE 2 PROPERTY DETAILS						
PROPERTY ACQUISITION REFERENCE	OWNER	ADDRESS	LEGAL DESCRIPTION	TITLE REFERENCE	AREA m <sup>2</sup>	
					REQUIRED FOR MOTORWAY	SEVERANCE
41	TEGEL FOODS LIMITED	282 MARSHS ROAD	LOT 1, DP 53739	CB31F/595	11462m <sup>2</sup>	
42	CALDER STEWART INDUSTRIES LIMITED	201 MARSH ROAD AND 4 SIR JAMES WATTIE DR.	LOT 2, DP 49203	387248.00	(42a) 46613m <sup>2</sup>	(42b) 40167m <sup>2</sup>
40	B&S HOUGHTON		LOT 1, DP 57203	CB33K/1059	3414m <sup>2</sup>	
183	MICHAEL STUART PETERS, ANNE FELICIA PETERS	270 MARSHS ROAD	LOT 2 DP 402608	480476	313m <sup>2</sup>	

**FOR CONSENT**

No	Revision	Note: * indicates signatures on original issue of drawing or last revision of drawing	Drawn	Checked	Approved	Date
0	FOR CONSENT		AF	DGA	GAP	29.08.12
B	FOR INFORMATION		CMD	DGA	CG	01.05.12
A	FOR INFORMATION		CMcG	DGA	CG	14.10.11



**DO NOT SCALE**

This drawing has been prepared for the benefit of the NZ Transport Agency (NZTA). No liability is accepted by these companies or any employee or sub-consultant of these companies with respect to its use by any other person.

This disclaimer shall apply notwithstanding that the drawing may be made available to other persons for an application for permission or approval or to fulfil a legal requirement.

Drawn	CMcG	Designed	JAS
Drafting Check	JAS	Design Check	DGA
Approved	GARY PAYNE		
Date	29.08.12		
A1 Scale	This Drawing must not be used for Construction unless signed as Approved		
A3 Scale	1:2000		

Client	NEW ZEALAND TRANSPORT AGENCY		
Project	SH1 REGION 11 RP350/3.92 TO RP365/2.11		
Title	CHRISTCHURCH SOUTHERN MOTORWAY STAGE 2 LAND REQUIREMENT PLAN - SHEET 10 OF 18		
Drawing No:	62236-B-C1110		Rev: 0

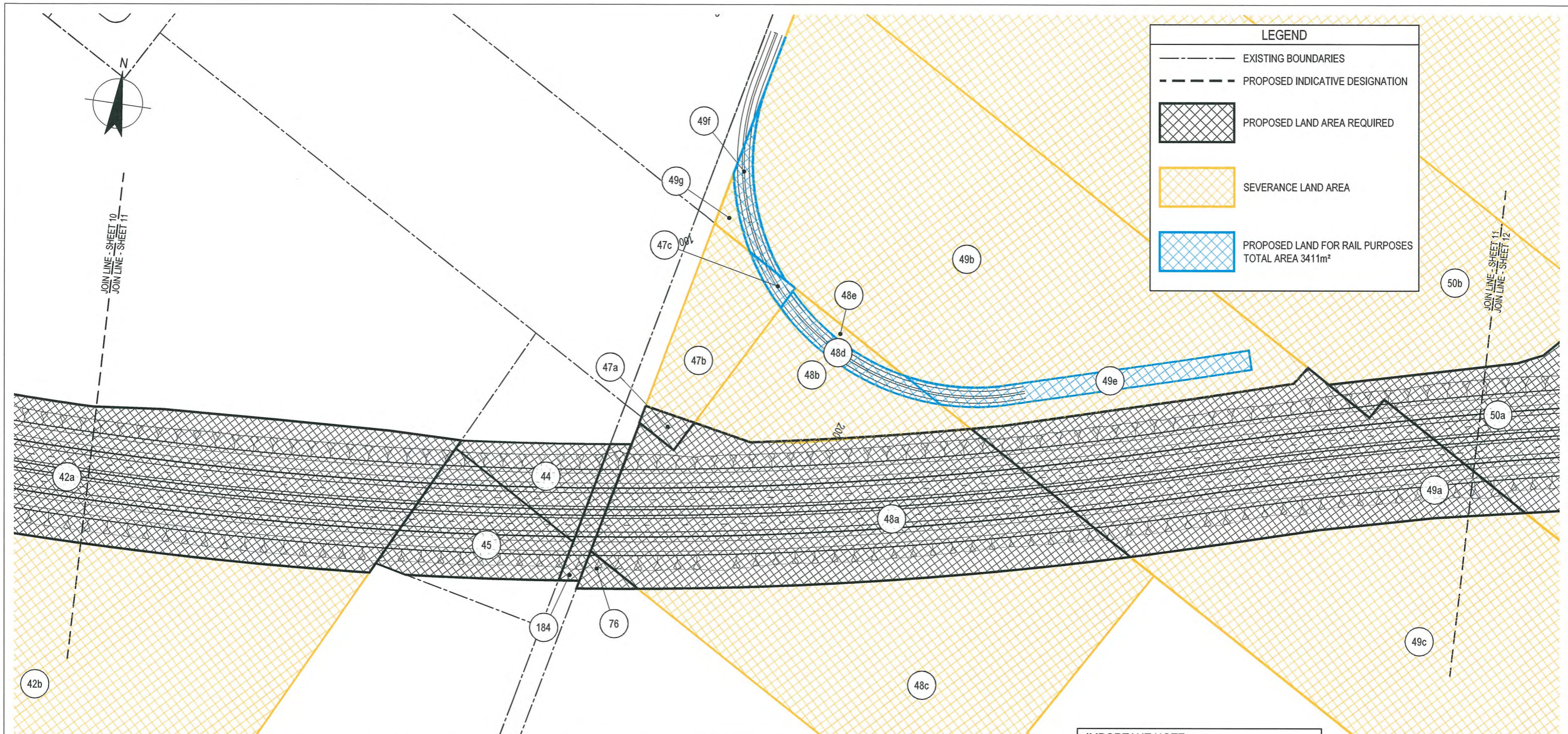

SOUTHERN MOTORWAY EXTENSION - STAGE 2 PROPERTY DETAILS

PROPERTY ACQUISITION REFERENCE	OWNER	ADDRESS	LEGAL DESCRIPTION	TITLE REFERENCE	AREA m²		
					REQUIRED FOR MOTORWAY	SEVERANCE	REQUIRED FOR RAILWAY
44	CALDER STEWART INDUSTRIES LIMITED	MARSHS ROAD	LOT 1, DP 397092	387248.00	2094m²		
45	PRESHES INVESTMENTS LIMITED	303 MARSHS ROAD	LOT 2, DP 397092	387249.00	3935m²		
76	FODDER CUBE PRODUCTS NORTH CANTERBURY LTD		LOT 1, DP 53489	CB31K/460	306m²		
47	SHANDS ROAD INDUSTRIAL PARK LIMITED		LOT 2, DP 61408	283701	(47a) 319m²	(47b) 3395m²	(47c) 210m²
48	KOVAN LIMITED	320 SPRINGS ROAD	LOT 2, DP 82095	CB47B/926	(48a) 17012m²	(48b) 4520m², (48c) 18913m², (48e) 352m²	(48d) 863m²
49	NZTA EX CARTER	300 SPRINGS ROAD	PT RS 1480	CB493/44	(49a) 14992m², (49d) 1338m²	(49b) 30812m², (49c) 23481m², (49g) 258m²	(49e) 1692m², (49f) 646m²
184	KIWI RAIL	RAILWAY	PT RS 2637		752m²		

**IMPORTANT NOTE:**  
THE AREAS AND LOCATIONS SHOWN ON THESE DRAWINGS ARE INDICATIVE ONLY AT THIS STAGE, AND ARE BASED ON CADASTRAL DATA PREDATING THE 4TH OF SEPTEMBER 2010 EARTHQUAKE

Approved  
  
 Colin MacKay  
 Project Management Services Manager, Christchurch  
 NZ Transport Agency  
 Date 18/10/12

FOR CONSENT

No	Revision	Note	Drawn	Checked	Approved	Date
0	FOR CONSENT		AF	DGA	GAP	29.08.12
B	FOR INFORMATION		CMD	DGA	CG	01.05.12
A	FOR INFORMATION		CMcG	DGA	CG	14.10.11



**DO NOT SCALE**  
 This drawing has been prepared for the benefit of the NZ Transport Agency (NZTA). No liability is accepted by these companies or any employee or sub-consultant of these companies with respect to its use by any other person.  
 This disclaimer shall apply notwithstanding that the drawing may be made available to other persons for an application for permission or approval or to fulfil a legal requirement.

Drawn	CMcG	Designed	JAS
Drafting Check	JAS	Design Check	DGA
Approved	GARY PAYNE		
Date	29.08.12		
A1 Scale			
A3 Scale	1:2000		



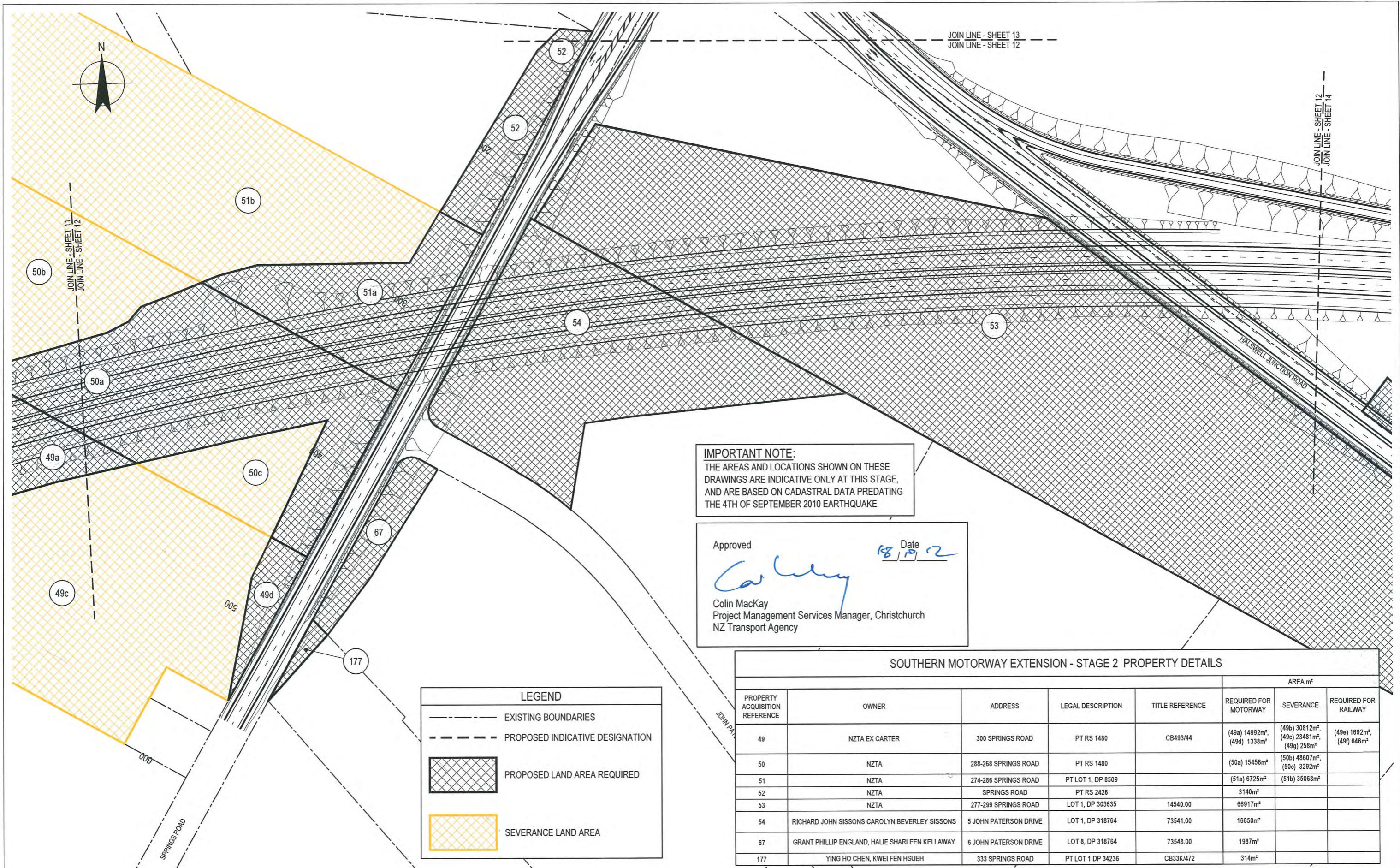

Client **NEW ZEALAND TRANSPORT AGENCY**  
 Project **SH1 REGION 11 RP350/3.92 TO RP365/2.11**  
 Title **CHRISTCHURCH SOUTHERN MOTORWAY 2 LAND REQUIREMENT PLAN - SHEET 11 OF 18**  
 Drawing No: **62236-B-C1111** Rev: **0**



**IMPORTANT NOTE:**  
 THE AREAS AND LOCATIONS SHOWN ON THESE DRAWINGS ARE INDICATIVE ONLY AT THIS STAGE, AND ARE BASED ON CADASTRAL DATA PREDATING THE 4TH OF SEPTEMBER 2010 EARTHQUAKE

Approved  
  
 Colin MacKay  
 Project Management Services Manager, Christchurch  
 NZ Transport Agency

Date 18/10/12

LEGEND	
	EXISTING BOUNDARIES
	PROPOSED INDICATIVE DESIGNATION
	PROPOSED LAND AREA REQUIRED
	SEVERANCE LAND AREA

SOUTHERN MOTORWAY EXTENSION - STAGE 2 PROPERTY DETAILS							
PROPERTY ACQUISITION REFERENCE	OWNER	ADDRESS	LEGAL DESCRIPTION	TITLE REFERENCE	AREA m <sup>2</sup>		
					REQUIRED FOR MOTORWAY	SEVERANCE	REQUIRED FOR RAILWAY
49	NZTA EX CARTER	300 SPRINGS ROAD	PT RS 1480	CB493/44	(49a) 14992m <sup>2</sup> , (49d) 1338m <sup>2</sup>	(49b) 30812m <sup>2</sup> , (49c) 23481m <sup>2</sup> , (49g) 258m <sup>2</sup>	(49e) 1692m <sup>2</sup> , (49f) 646m <sup>2</sup>
50	NZTA	288-286 SPRINGS ROAD	PT RS 1480		(50a) 15456m <sup>2</sup>	(50b) 48607m <sup>2</sup> , (50c) 3292m <sup>2</sup>	
51	NZTA	274-286 SPRINGS ROAD	PT LOT 1, DP 8509		(51a) 6725m <sup>2</sup>	(51b) 35068m <sup>2</sup>	
52	NZTA	SPRINGS ROAD	PT RS 2426		3140m <sup>2</sup>		
53	NZTA	277-299 SPRINGS ROAD	LOT 1, DP 303635	14540.00	66917m <sup>2</sup>		
54	RICHARD JOHN SISSONS CAROLYN BEVERLEY SISSONS	5 JOHN PATERSON DRIVE	LOT 1, DP 318764	73541.00	16650m <sup>2</sup>		
67	GRANT PHILLIP ENGLAND, HALIE SHARLEEN KELLAWAY	6 JOHN PATERSON DRIVE	LOT 8, DP 318764	73548.00	1987m <sup>2</sup>		
177	YING HO CHEN, KWEI FEN HSUEH	333 SPRINGS ROAD	PT LOT 1 DP 34236	CB33K/472	314m <sup>2</sup>		

**FOR CONSENT**

No	Revision	Note: * indicates signatures on original issue of drawing or last revision of drawing	Drawn	Checked	Approved	Date
0	FOR CONSENT		AF	DGA	GAP	29.08.12
B	FOR INFORMATION		CMD	DGA	CG	01.05.12
A	FOR INFORMATION		CMcG	DGA	CG	14.10.11



**DO NOT SCALE**  
 This drawing has been prepared for the benefit of the NZ Transport Agency (NZTA). No liability is accepted by these companies or any employee or sub-consultant of these companies with respect to its use by any other person. This disclaimer shall apply notwithstanding that the drawing may be made available to other persons for an application for permission or approval or to fulfil a legal requirement.

Drawn CMcG  
 Designed JAS  
 Drafting JAS  
 Design Check DGA  
 Approved GARY PAYNE  
 Date 29.08.12  
 A1 Scale  
 A3 Scale 1:2000

Client  
 Project  
 Title  
 Drawing No: **62236-B-C1112** Rev: 0

**NEW ZEALAND TRANSPORT AGENCY**  
**SH1 REGION 11 RP350/3.92 TO RP365/2.11**  
**CHRISTCHURCH SOUTHERN MOTORWAY STAGE 2**  
**LAND REQUIREMENT PLAN - SHEET 12 OF 18**

SOUTHERN MOTORWAY EXTENSION - STAGE 2 PROPERTY DETAILS						AREA m <sup>2</sup>	
PROPERTY ACQUISITION REFERENCE	OWNER	ADDRESS	LEGAL DESCRIPTION	TITLE REFERENCE	REQUIRED FOR MOTORWAY	SEVERANCE	
52	NZTA	SPRINGS ROAD	PT RS 2426		3140m <sup>2</sup>		

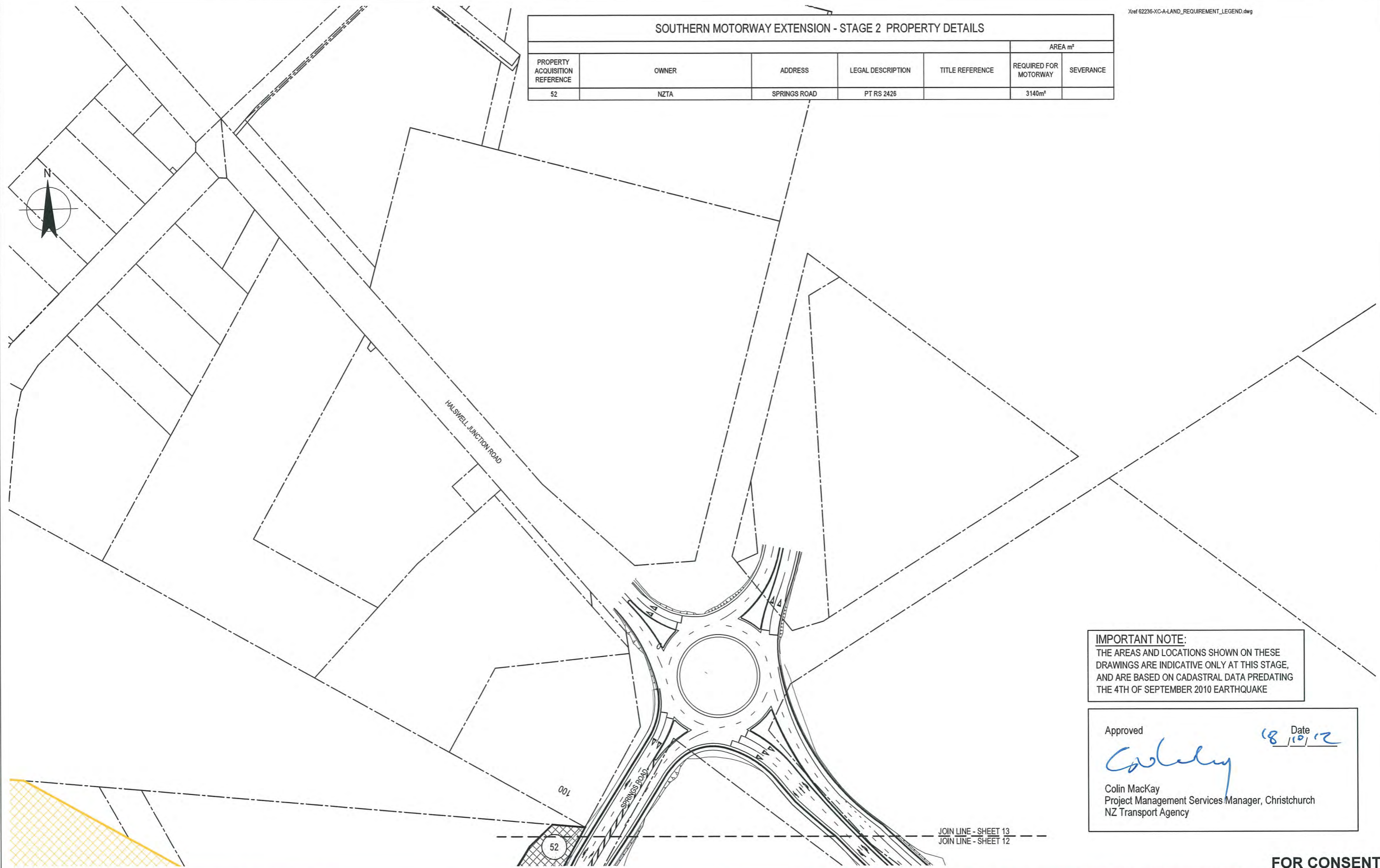

**IMPORTANT NOTE:**  
 THE AREAS AND LOCATIONS SHOWN ON THESE DRAWINGS ARE INDICATIVE ONLY AT THIS STAGE, AND ARE BASED ON CADASTRAL DATA PREDATING THE 4TH OF SEPTEMBER 2010 EARTHQUAKE

Approved Date 18/10/12  
  
 Colin MacKay  
 Project Management Services Manager, Christchurch  
 NZ Transport Agency

JOIN LINE - SHEET 13  
 JOIN LINE - SHEET 12

**FOR CONSENT**

No	Revision	Note: * indicates signatures on original issue of drawing or last revision of drawing	Drawn	Checked	Approved	Date
0	FOR CONSENT		AF	DGA	GAP	29.08.12
B	FOR INFORMATION		CMD	DGA	CG	01.05.12
A	FOR INFORMATION		CMcG	DGA	CG	14.10.11



**DO NOT SCALE**  
 This drawing has been prepared for the benefit of the NZ Transport Agency (NZTA). No liability is accepted by these companies or any employee or sub-consultant of these companies with respect to its use by any other person.  
 This disclaimer shall apply notwithstanding that the drawing may be made available to other persons for an application for permission or approval or to fulfil a legal requirement.





Drawn	CMcG	Designed	JAS
Drafting Check	JAS	Design Check	DGA
Approved	GARY PAYNE		
Date	29.08.12		
A1 Scale	This Drawing must not be used for Construction unless signed as Approved		
A3 Scale	1:2000		

Client	<b>NEW ZEALAND TRANSPORT AGENCY</b>		
Project	<b>SH1 REGION 11 RP350/3.92 TO RP365/2.11</b>		
Title	<b>CHRISTCHURCH SOUTHERN MOTORWAY STAGE 2 LAND REQUIREMENT PLAN - SHEET 13 OF 18</b>		
Drawing No:	<b>62236-B-C1113</b>	Rev:	<b>0</b>

SOUTHERN MOTORWAY EXTENSION - STAGE 2 PROPERTY DETAILS

PROPERTY ACQUISITION REFERENCE	OWNER	ADDRESS	LEGAL DESCRIPTION	TITLE REFERENCE	AREA m <sup>2</sup>	
					REQUIRED FOR MOTORWAY	SEVERANCE
55	CHRISTCHURCH CITY COUNCIL	434-502 HALSWELL JUNCTION ROAD	PT LOT 1, DP 45957	CB24F/296	2513m <sup>2</sup>	
71	JOHN GREGORY KEITH OLIVE	419 HALSWELL JUNCTION ROAD	LOT 1, DP 60678	CB36A/670	8873m <sup>2</sup>	
72	MEE LAI LEE BAK CHEONG LEE	402 HALSWELL JUNCTION ROAD	PT LOT 1, DP 42549	CB20B/292	33600m <sup>2</sup>	

LEGEND

	EXISTING BOUNDARIES
	PROPOSED INDICATIVE DESIGNATION
	PROPOSED LAND AREA REQUIRED
	SEVERANCE LAND AREA

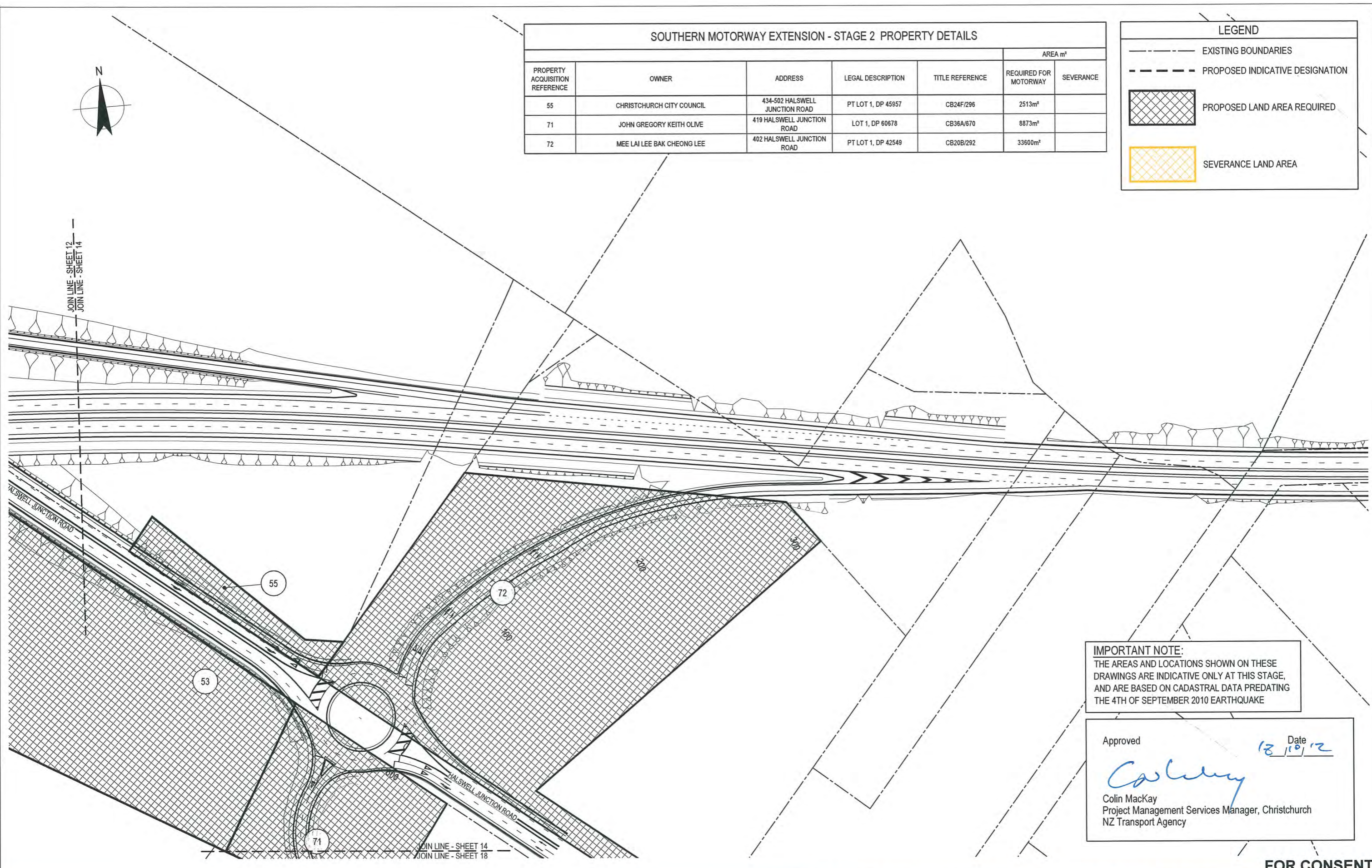

**IMPORTANT NOTE:**  
THE AREAS AND LOCATIONS SHOWN ON THESE DRAWINGS ARE INDICATIVE ONLY AT THIS STAGE, AND ARE BASED ON CADASTRAL DATA PREDATING THE 4TH OF SEPTEMBER 2010 EARTHQUAKE

Approved  Date 13/10/12  
Colin MacKay  
Project Management Services Manager, Christchurch  
NZ Transport Agency

**FOR CONSENT**

No	Revision	Note	Drawn	Checked	Approved	Date
0	FOR CONSENT		AF	DGA	GAP	29.08.12
B	FOR INFORMATION		CMD	DGA	CG	01.05.12
A	FOR INFORMATION		CMcG	DGA	CG	14.10.11



<b>DO NOT SCALE</b>	Drawn CMcG	Designed JAS
<small>This drawing has been prepared for the benefit of the NZ Transport Agency (NZTA). No liability is accepted by these companies or any employee or sub-consultant of these companies with respect to its use by any other person. This disclaimer shall apply notwithstanding that the drawing may be made available to other persons for an application for permission or approval or to fulfil a legal requirement.</small>	Drafting Check JAS	Design Check DGA
	Approved GARY PAYNE	
	Date 29.08.12	
A1 Scale	This Drawing must not be used for Construction unless signed as Approved	
A3 Scale 1:2000		

Client	<b>NEW ZEALAND TRANSPORT AGENCY</b>
Project	<b>SH1 REGION 11 RP350/3.92 TO RP365/2.11</b>
Title	<b>CHRISTCHURCH SOUTHERN MOTORWAY STAGE 2 LAND REQUIREMENT PLAN - SHEET 14 OF 18</b>
Drawing No:	<b>62236-B-C1114</b>
Rev:	<b>0</b>



LEGEND	
	EXISTING BOUNDARIES
	PROPOSED INDICATIVE DESIGNATION
	PROPOSED LAND AREA REQUIRED
	SEVERANCE LAND AREA

**IMPORTANT NOTE:**  
THE AREAS AND LOCATIONS SHOWN ON THESE DRAWINGS ARE INDICATIVE ONLY AT THIS STAGE, AND ARE BASED ON CADASTRAL DATA PREDATING THE 4TH OF SEPTEMBER 2010 EARTHQUAKE

Approved  
*Colin MacKay*  
Colin MacKay  
Project Management Services Manager, Christchurch  
NZ Transport Agency  
Date 18/10/12

**SOUTHERN MOTORWAY EXTENSION - STAGE 2 PROPERTY DETAILS**

PROPERTY ACQUISITION REFERENCE	OWNER	ADDRESS	LEGAL DESCRIPTION	TITLE REFERENCE	AREA m <sup>2</sup>	
					REQUIRED FOR MOTORWAY	SEVERANCE
13	NZTA EX HEALD	891 WATERHOLES ROAD	LOT 1, DP 26707	CB8F/31	(13a) 34064m <sup>2</sup>	(13b) 19973m <sup>2</sup> , (13c) 18423m <sup>2</sup>
15	JOHN RONALD TATE GAYLENE ELIZABETH TATE	517 HAMPTON ROAD	LOT 2, DP 341197	169382.00	(15a) 12928m <sup>2</sup>	(15b) 5497m <sup>2</sup> , (15c) 24578m <sup>2</sup>
16	NZTA EX WADSWORTH	544 HAMPTONS ROAD	LOT 1, DP 408618	431405.00	(16a) 20131m <sup>2</sup>	(16b) 12449m <sup>2</sup> , (16c) 7420m <sup>2</sup>
17	JOHN RONALD TATE GAYLENE ELIZABETH TATE	517 HAMPTON ROAD	LOT 1, DP 341197	169381	993m <sup>2</sup>	
18	EMMA JOY STEEL MICHAEL JOSEPH SWEENEY	HAMPTONS ROAD	LOT 2, DP 408618	431404.00	(18a) 683m <sup>2</sup> , (18b) 2013m <sup>2</sup>	
19	NZTA EX RLM	HAMPTONS ROAD	LOT 3, DP 408618	431406.00	(19a) 29471m <sup>2</sup> , (19e) 141m <sup>2</sup>	(19b) 73562m <sup>2</sup> , (19c) 18684m <sup>2</sup> , (19d) 1756m <sup>2</sup>

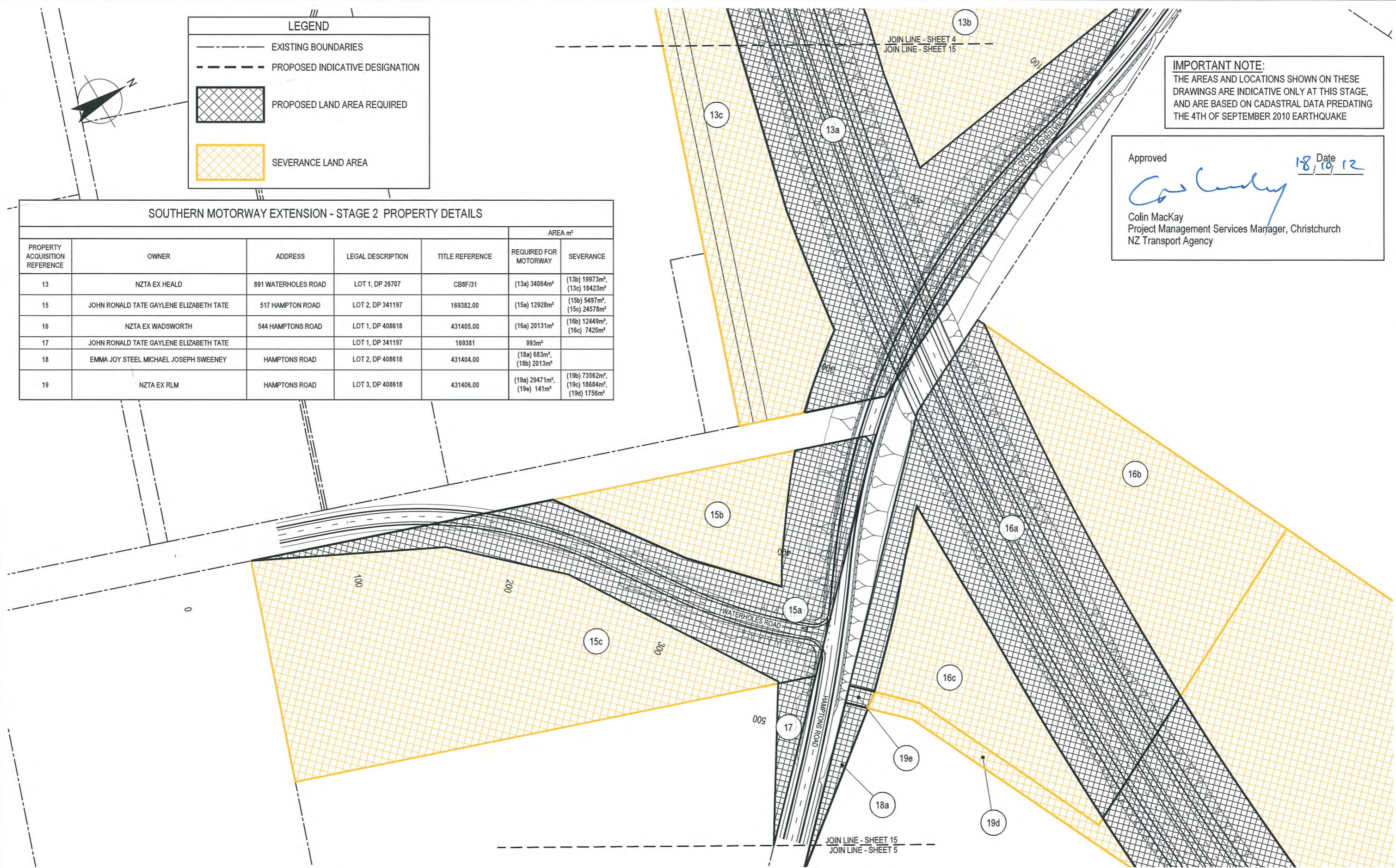

**FOR CONSENT**

No	Revision	Note	Drawn	Checked	Approved	Date
0	FOR CONSENT		AF	DGA	GAP	29.08.12
B	FOR INFORMATION		CMD	DGA	CG	01.05.12
A	FOR INFORMATION		CMcG	DGA	CG	14.10.11



**DO NOT SCALE**  
This drawing has been prepared for the benefit of the NZ Transport Agency (NZTA). No liability is accepted by these companies or any employee or sub-consultant of these companies with respect to its use by any other person.  
This disclaimer shall apply notwithstanding that the drawing may be made available to other persons for an application for permission or approval or to fulfil a legal requirement.

Drawn	CMcG	Designed	JAS
Drafting Check	JAS	Design Check	DGA
Approved	GARY PAYNE		
Date	29.08.12		
A1 Scale	1:2000	This Drawing must not be used for Construction unless signed as Approved	
A3 Scale			

Client	NEW ZEALAND TRANSPORT AGENCY		
Project	SH1 REGION 11 RP350/3.92 TO RP365/2.11		
Title	CHRISTCHURCH SOUTHERN MOTORWAY STAGE 2 LAND REQUIREMENT PLAN - SHEET 15 OF 18		
Drawing No:	62236-B-C1115	Rev:	0





LEGEND	
	EXISTING BOUNDARIES
	PROPOSED INDICATIVE DESIGNATION
	PROPOSED LAND AREA REQUIRED
	SEVERANCE LAND AREA

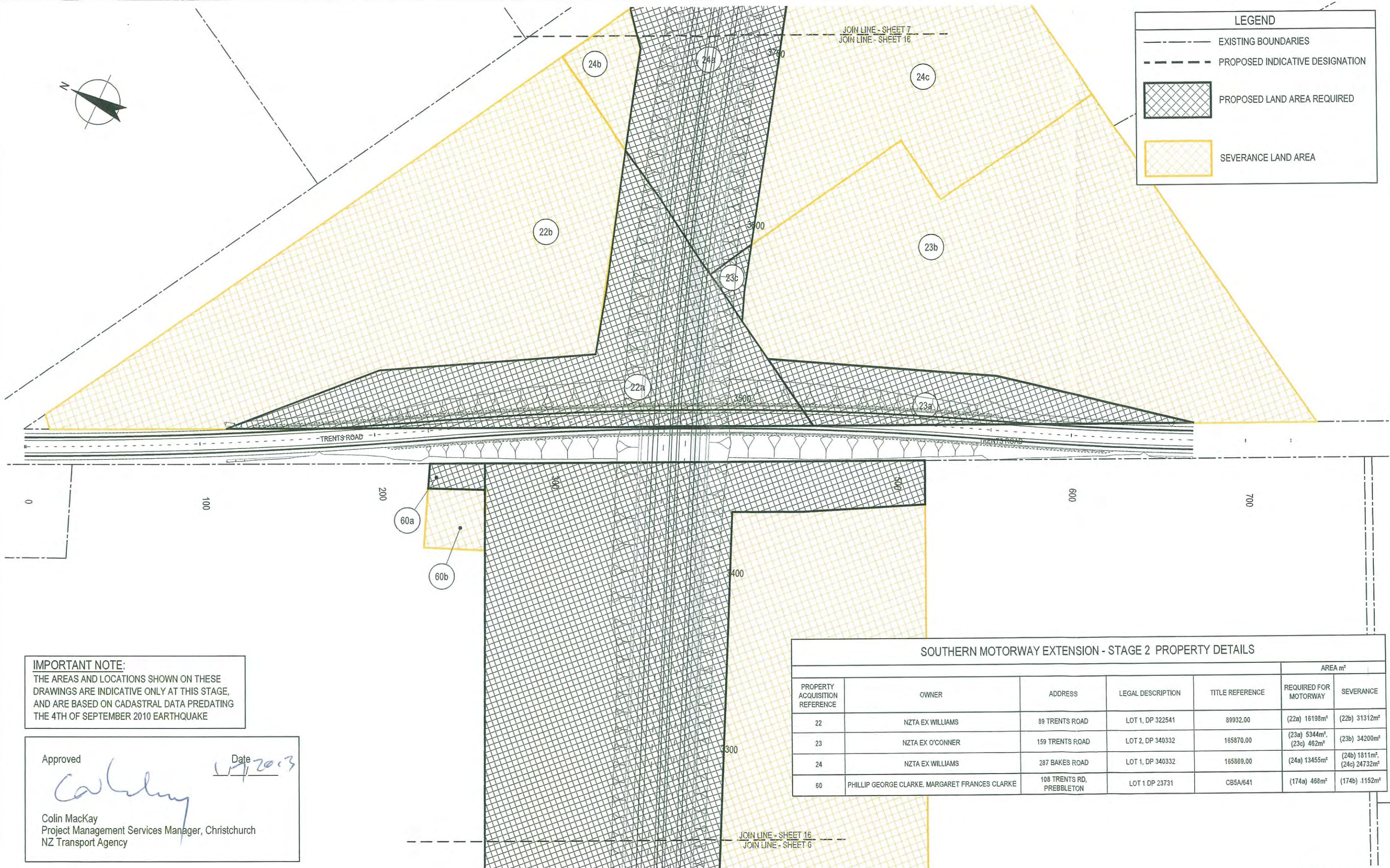

**IMPORTANT NOTE:**  
THE AREAS AND LOCATIONS SHOWN ON THESE DRAWINGS ARE INDICATIVE ONLY AT THIS STAGE, AND ARE BASED ON CADASTRAL DATA PREDATING THE 4TH OF SEPTEMBER 2010 EARTHQUAKE

Approved  Date 17/10/2013  
Colin MacKay  
Project Management Services Manager, Christchurch  
NZ Transport Agency

SOUTHERN MOTORWAY EXTENSION - STAGE 2 PROPERTY DETAILS						
PROPERTY ACQUISITION REFERENCE	OWNER	ADDRESS	LEGAL DESCRIPTION	TITLE REFERENCE	AREA m <sup>2</sup>	
					REQUIRED FOR MOTORWAY	SEVERANCE
22	NZTA EX WILLIAMS	89 TRENTS ROAD	LOT 1, DP 322541	89932.00	(22a) 16198m <sup>2</sup>	(22b) 31312m <sup>2</sup>
23	NZTA EX O'CONNOR	159 TRENTS ROAD	LOT 2, DP 340332	165870.00	(23a) 5344m <sup>2</sup> (23c) 462m <sup>2</sup>	(23b) 34200m <sup>2</sup>
24	NZTA EX WILLIAMS	287 BAKES ROAD	LOT 1, DP 340332	165869.00	(24a) 13455m <sup>2</sup>	(24b) 1811m <sup>2</sup> (24c) 24732m <sup>2</sup>
60	PHILLIP GEORGE CLARKE, MARGARET FRANCES CLARKE	108 TRENTS RD, PREBBLETON	LOT 1 DP 23731	CB5A/641	(174a) 468m <sup>2</sup>	(174b) 1152m <sup>2</sup>

**FOR CONSENT**

No	Revision	Note	Drawn	Checked	Approved	Date
1	FOR HEARING		JAL	DGA	JAL	28.06.13
0	FOR CONSENT		AF	DGA	GAP	29.08.12
B	FOR INFORMATION		CMD	DGA	CG	01.05.12
A	FOR INFORMATION		CMcG	DGA	CG	14.10.11



**DO NOT SCALE**  
This drawing has been prepared for the benefit of the NZ Transport Agency (NZTA). No liability is accepted by these companies or any employee or sub-consultant of these companies with respect to its use by any other person.  
This disclaimer shall apply notwithstanding that the drawing may be made available to other persons for an application for permission or approval or to fulfil a legal requirement.

Drawn CMcG    Designed JAS  
Drafting JAS    Design Check DGA  
Approved GARY PAYNE  
Date 29.08.12  
A1 Scale  
A3 Scale 1:2000

Client **NEW ZEALAND TRANSPORT AGENCY**  
Project **SH1 REGION 11 RP350/3.92 TO RP365/2.11**  
Title **CHRISTCHURCH SOUTHERN MOTORWAY STAGE 2 LAND REQUIREMENT PLAN - SHEET 16 OF 18**  
Drawing No: **62236-B-C1116**    Rev: **1**

SOUTHERN MOTORWAY EXTENSION - STAGE 2 PROPERTY DETAILS

PROPERTY ACQUISITION REFERENCE	OWNER	ADDRESS	LEGAL DESCRIPTION	TITLE REFERENCE	AREA m <sup>2</sup>	
					REQUIRED FOR MOTORWAY	SEVERANCE
34	TEGEL FOODS LIMITED	516/518 SHANDS ROAD	LOT 1, DP 53738	CB31F/593	(34a) 24085m <sup>2</sup>	(34b) 4290m <sup>2</sup>
38	FODDERCUBE PRODUCTS NTH CANTY LIMITED	SHANDS ROAD	LOT 2, DP 24365	CB8K/984	24149m <sup>2</sup>	
39	BENJAMIN WILLIAM MCALPINE TOTHILL SALLY JEAN TOTHILL	246 MARSHS AND 493 SHANDS ROAD	LOT 1, DP 24365	CB12B/1269	84741m <sup>2</sup>	
65	NOEL LINDSAY MOORE	197 MARSHS ROAD	LOT 2 DP 64487	CB35D/1273	402m <sup>2</sup>	
66	NZTA	199 MARSHS ROAD	LOT 1 DP 19825	CB756/94	259m <sup>2</sup>	
31	CHELANDRY FARMS LIMITED	544 SHANDS ROAD	LOT 1 DP 310929	43002	181m <sup>2</sup>	

LEGEND	
	EXISTING BOUNDARIES
	PROPOSED INDICATIVE DESIGNATION
	PROPOSED LAND AREA REQUIRED
	SEVERANCE LAND AREA

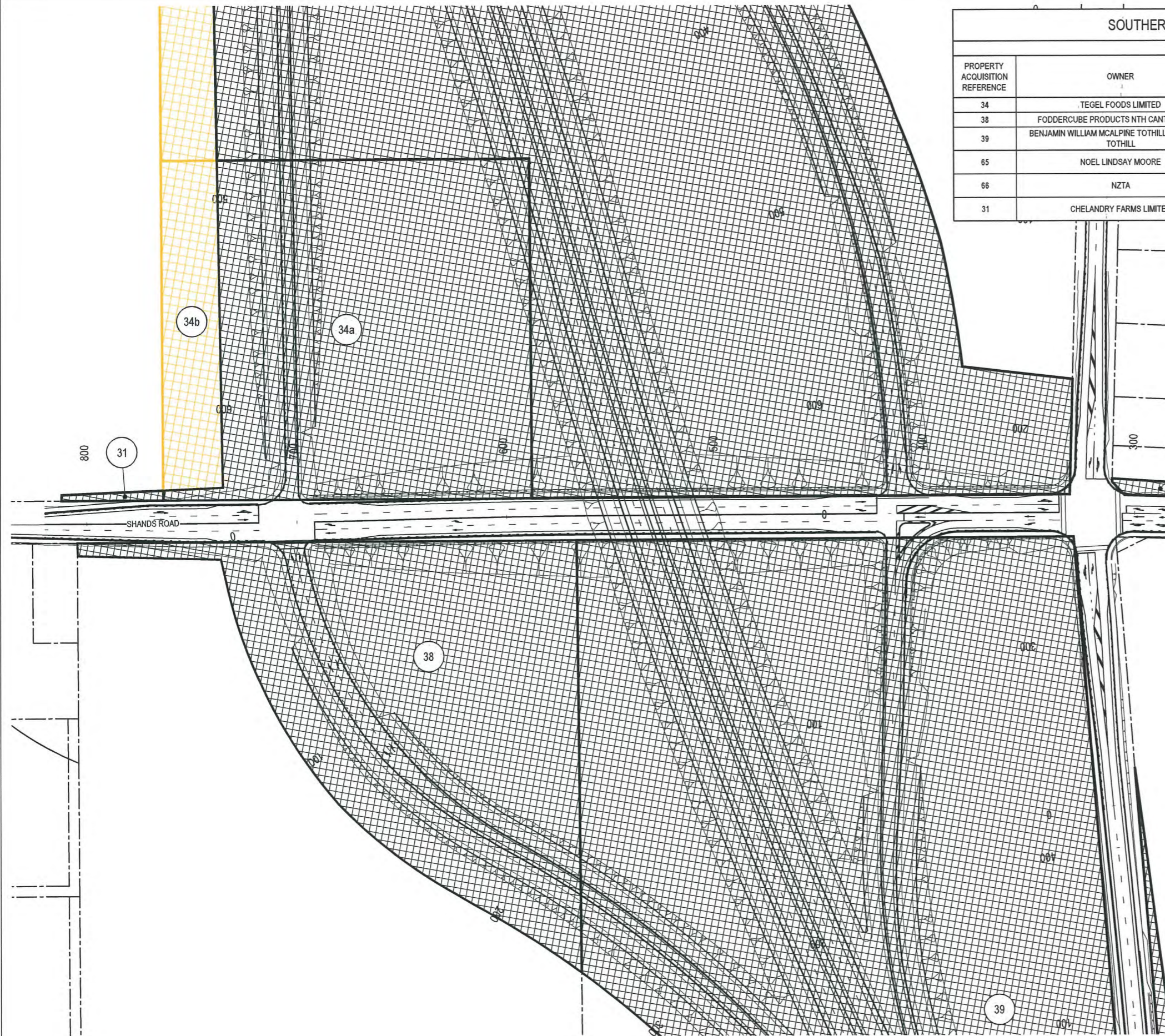

**IMPORTANT NOTE:**  
THE AREAS AND LOCATIONS SHOWN ON THESE DRAWINGS ARE INDICATIVE ONLY AT THIS STAGE, AND ARE BASED ON CADASTRAL DATA PREDATING THE 4TH OF SEPTEMBER 2010 EARTHQUAKE



Approved  Date 18/10/12  
Colin MacKay  
Project Management Services Manager, Christchurch  
NZ Transport Agency

**FOR CONSENT**

No	Revision	Note: * indicates signatures on original issue of drawing or last revision of drawing	Drawn	Checked	Approved	Date
0	FOR CONSENT		AF	DGA	GAP	29.08.12
B	FOR INFORMATION		CMD	DGA	CG	01.05.12
A	FOR INFORMATION		CMcG	DGA	CG	14.10.11



DO NOT SCALE	
Drawn	CMcG
Designed	JAS
Drafting Check	JAS
Design Check	DGA
Approved	GARY PAYNE
Date	29.08.12
A1 Scale	
A3 Scale	1:2000

Client	NEW ZEALAND TRANSPORT AGENCY
Project	SH1 REGION 11 RP350/3.92 TO RP365/2.11
Title	CHRISTCHURCH SOUTHERN MOTORWAY STAGE 2 LAND REQUIREMENT PLANS - SHEET 17 OF 18
Drawing No:	62236-B-C1117
Rev:	0



**LEGEND**

- EXISTING BOUNDARIES
- PROPOSED INDICATIVE DESIGNATION
- PROPOSED LAND AREA REQUIRED
- SEVERANCE LAND AREA

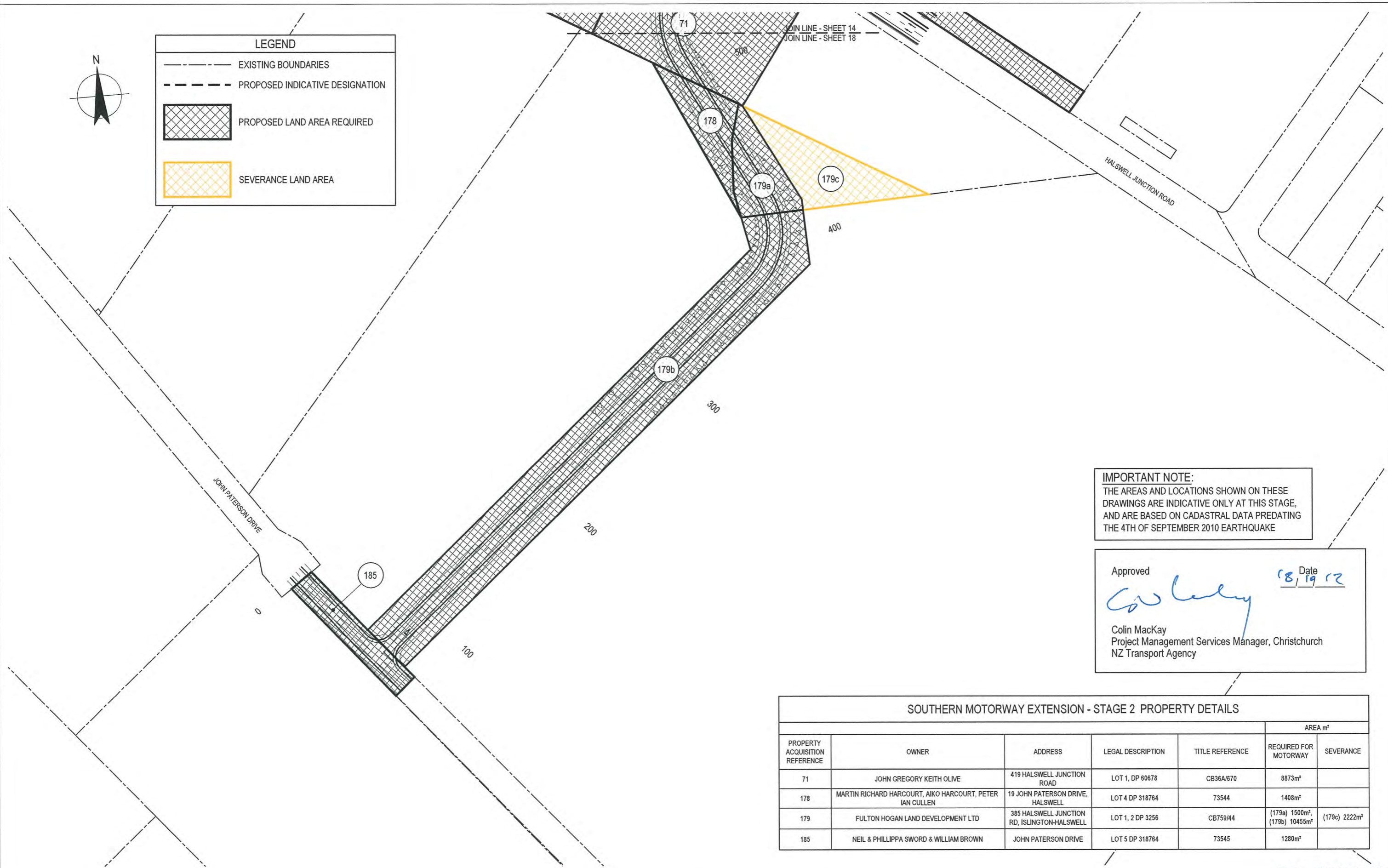

**IMPORTANT NOTE:**  
 THE AREAS AND LOCATIONS SHOWN ON THESE DRAWINGS ARE INDICATIVE ONLY AT THIS STAGE, AND ARE BASED ON CADASTRAL DATA PREDATING THE 4TH OF SEPTEMBER 2010 EARTHQUAKE

Approved  Date 18/10/12  
 Colin MacKay  
 Project Management Services Manager, Christchurch  
 NZ Transport Agency

SOUTHERN MOTORWAY EXTENSION - STAGE 2 PROPERTY DETAILS						
PROPERTY ACQUISITION REFERENCE	OWNER	ADDRESS	LEGAL DESCRIPTION	TITLE REFERENCE	AREA m <sup>2</sup>	
					REQUIRED FOR MOTORWAY	SEVERANCE
71	JOHN GREGORY KEITH OLIVE	419 HALSWELL JUNCTION ROAD	LOT 1, DP 60678	CB36A/670	8873m <sup>2</sup>	
178	MARTIN RICHARD HARCOURT, AIKO HARCOURT, PETER IAN CULLEN	19 JOHN PATERSON DRIVE, HALSWELL	LOT 4 DP 318764	73544	1408m <sup>2</sup>	
179	FULTON HOGAN LAND DEVELOPMENT LTD	385 HALSWELL JUNCTION RD, ISLINGTON-HALSWELL	LOT 1, 2 DP 3256	CB759/44	(179a) 1500m <sup>2</sup> , (179b) 10455m <sup>2</sup>	(179c) 2222m <sup>2</sup>
185	NEIL & PHILLIPPA SWORD & WILLIAM BROWN	JOHN PATERSON DRIVE	LOT 5 DP 318764	73545	1280m <sup>2</sup>	

**FOR CONSENT**

No	Revision	Note	Drawn	Checked	Approved	Date
0	FOR CONSENT		AF	DGA	GAP	29.08.12
A	FOR INFORMATION		CMD	DGA	CG	01.05.12



**DO NOT SCALE**

This drawing has been prepared for the benefit of the NZ Transport Agency (NZTA). No liability is accepted by these companies or any employee or sub-consultant of these companies with respect to its use by any other person.

This disclaimer shall apply notwithstanding that the drawing may be made available to other persons for an application for permission or approval or to fulfil a legal requirement.

Drawn CMcG    Designed JAS  
 Drafting Check JAS    Design Check DGA  
 Approved GARY PAYNE  
 Date 29.08.12  
 A1 Scale  
 A3 Scale 1:2000

Client **NEW ZEALAND TRANSPORT AGENCY**  
 Project **SH1 REGION 11 RP350/3.92 TO RP365/2.11**  
 Title **CHRISTCHURCH SOUTHERN MOTORWAY STAGE 2 LAND REQUIREMENT PLAN - SHEET 18 OF 18**

Drawing No: **62236-B-C1118**    Rev: **0**